

City of Centerville

Public Works Department
7970 South Suburban Road
Centerville, Ohio 45458
(937) 428-4782



Standard Construction Drawings

Revised 2/1/2023

TABLE OF CONTENTS

Item No.	Title	Sheet #
C202/C609	Curb Replacement on Asphalt Roadway	1
C202/C609	Curb Replacement on Existing Asphalt on Concrete Base Road	2
C202/C609	Curb Replacement on Existing Exposed Concrete Roadway	3
C252	Full-Depth Rigid Pavement Removal & Flexible Replacement	4
C252/C253	Full-Depth Pavement Repair	5
C253	Full-Depth Flexible Pavement Repair	6
C448	Commercial Asphalt Drive Apron	7
C448	Residential Asphalt Drive Apron	8
C452	Commercial Concrete Drive Apron	9
C452	Residential Concrete Drive Apron	10
C452	Yankee Trace Drive Apron	11
C605	Underdrain	12
C609	Concrete Median	13
C609	Curb	14
C811	Catch Basin	15
Special	Brick Sidewalk	16
Special	Concrete Crosswalk Headers	17
Special	Concrete Ditch and Side Panel Key Detail	18
Special	Mailbox	19
Special	Multi-Use Trail - Yankee Trace	20
Special	Multi-Use Trail	21
Special	Pavement Sections	22
Special	Pop-Up Detail	23
Special	Roadway / Right of Way Cuts	24
Special	Sump Line Connection	25

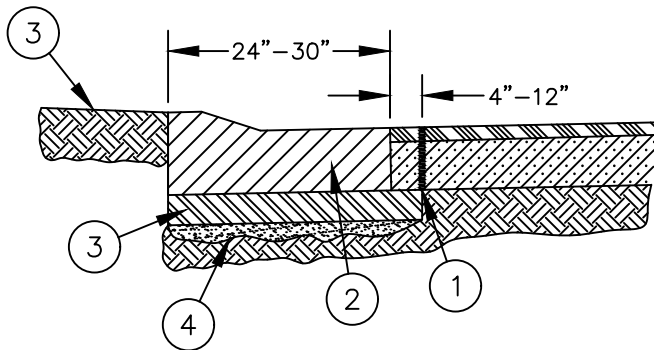

TYPICAL DEMOLITION DETAIL
NTS

DEMOLITION LEGEND

- ① SAW CUT EXISTING PAVEMENT (FULL DEPTH) 4"-12" IN FRONT OF CONCRETE CURB.*
- ② ITEM C202 – CURB AND GUTTER REMOVED
- ③ ITEM 203 – 4" EXCAVATION
- ④ ITEM C203 – UNDERCUTTING, AS DIRECTED BY ENGINEER

*SAW CUT WIDTH SHALL ALLOW SPACE REQUIRED TO FORM, BACKFILL, AND MECHANICALLY COMPACT RESTORED AREA IF NOT USING LSM RESTORATION

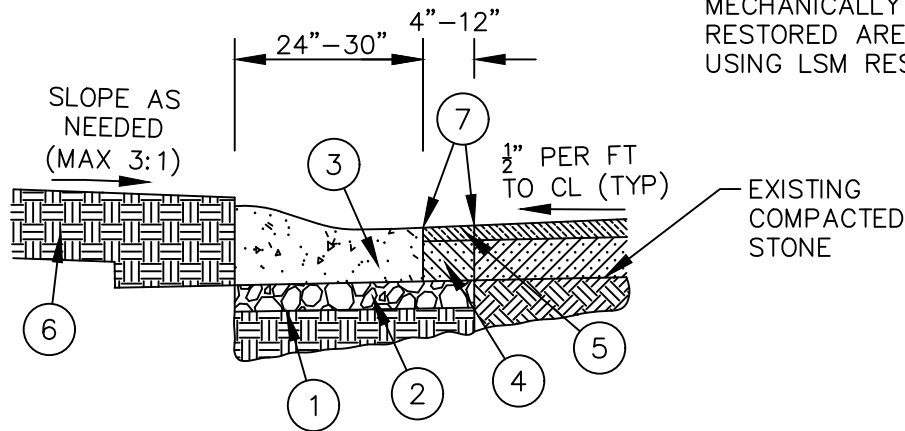

TYPICAL IMPROVEMENT DETAIL
NTS

IMPROVEMENT LEGEND

- ① ITEM 204 – SUBGRADE COMPACTION
- ② ITEM 304 – AGGREGATE BASE, 4" MIN
- ③ ITEM C609 – CURB, MATCH EXISTING TYPE
- ④ ITEM 613 – LOW STRENGTH MORTAR BACKFILL 100 PSI, 2" BELOW SURFACE
- ⑤ ITEM C441 – TYPE I ASPHALT CONCRETE SURFACE COURSE (448), MEDIUM TRAFFIC, PG64-22, 2" THICK, PLACED IN 2 LIFTS, OR AS SPECIFIED BY ENGINEER
- ⑥ ITEM 653 – 6-8" OF TOPSOIL FURNISHED AND PLACED TO 1" ABOVE CURB
ITEM C659 – SEEDING AND MULCHING
- ⑦ SEAL ALL VERTICAL FACES PER ODOT 401.14 AND SURFACE JOINTS WITH 4" AC RIBBON, IF PROJECT ISN'T GETTING PAVED THE FOLLOWING YEAR (PER ENGINEER'S DIRECTION)



CITY OF
CENTERVILLE, OH
PUBLIC WORKS DEPARTMENT
7970 SOUTH SUBURBAN ROAD
CENTERVILLE, OHIO 45458
PHONE (937) 428-4782
FAX (937) 433-0286

C202 & C609 –
CURB
REPLACEMENT ON
ASPHALT ROADWAY

Approval:
JAMES G. BRINEGAR
James Brinegar
City Engineer

Date: Jan. 2018
Revision: Jan. 2021

SHEET
1

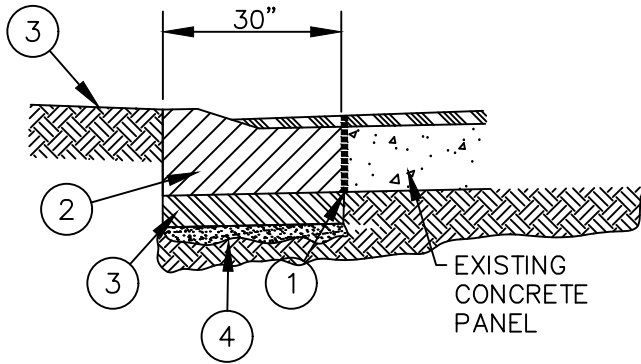

TYPICAL DEMOLITION DETAIL
NTS

DEMOLITION LEGEND

- ① ITEM 202 – SAW CUT EXISTING PAVEMENT (FULL DEPTH)
- ② ITEM C202 – CURB AND GUTTER REMOVED, ISOLATED
- ③ ITEM 203 – EXCAVATION
- ④ ITEM C203 – UNDERCUTTING, AS DIRECTED BY ENGINEER

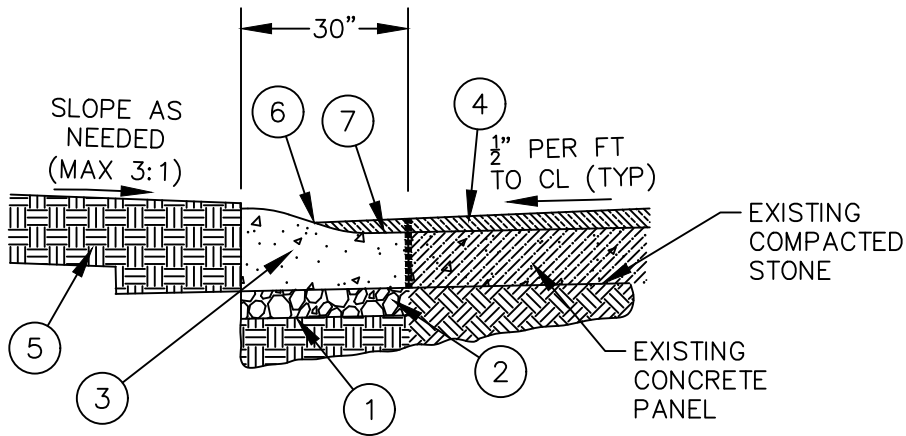

TYPICAL IMPROVEMENT DETAIL
NTS

IMPROVEMENT LEGEND

- ① ITEM 204 – SUBGRADE COMPACTION
- ② ITEM 304 – AGGREGATE BASE, 4" MIN
- ③ ITEM C609 – CURBING, MATCH EXISTING TYPE
- ④ ITEM C441 – TYPE 1 ASPHALT CONCRETE SURFACE COURSE (448), MEDIUM TRAFFIC PG64-22, 2" THICK PLACED IN 2 LIFTS OR AS SPECIFIED BY ENGINEER
- ⑤ ITEM 653 – 6-8" OF TOPSOIL FURNISHED AND PLACED TO 1" ABOVE CURB
ITEM C659 – SEEDING AND MULCHING
- ⑥ SEAL ALL VERTICAL FACES AND GUTTER TO BE COVERED PER ODOT 401.14 AND SURFACE JOINTS WITH 4" AC RIBBON
- ⑦ CURB MUST BE TACKED



CITY OF
CENTERVILLE, OH
PUBLIC WORKS DEPARTMENT
7970 SOUTH SUBURBAN ROAD
CENTERVILLE, OHIO 45458
PHONE (937) 428-4782
FAX (937) 433-0286

C202 & C609 CURB
REPLACEMENT ON
EXISTING ASPHALT ON
CONCRETE BASE ROADWAY
/ ASPHALT OVERLAYED
CURB & GUTTER

Approval:
JAMES G. BRINEGAR
James Brinegar
City Engineer

Date: Jan. 2018
Revision: Jan. 2021

SHEET
2

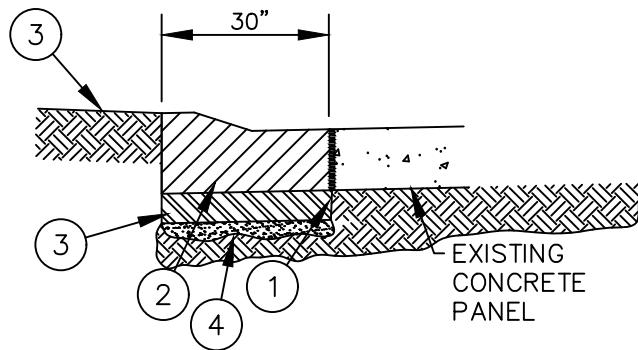

TYPICAL DEMOLITION DETAIL
NTS

DEMOLITION LEGEND

- ① SAW CUT EXISTING PAVEMENT (FULL DEPTH)
- ② ITEM C202 – CURB AND GUTTER REMOVED, ISOLATED
- ③ ITEM 203 – EXCAVATION
- ④ ITEM C203 – UNDERCUTTING, AS REQUIRED

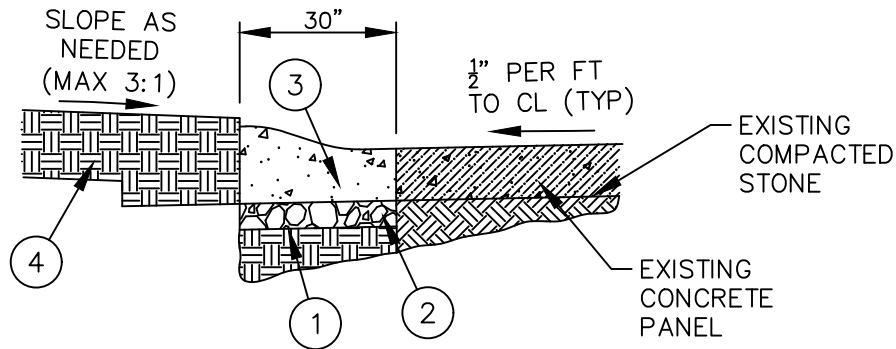

TYPICAL IMPROVEMENT DETAIL
NTS

IMPROVEMENT LEGEND

- ① ITEM 204 – SUBGRADE COMPACTION
- ② ITEM 304 – AGGREGATE BASE, 4" MIN
- ③ ITEM C609 – CURBING, MATCH EXISTING TYPE
- ④ ITEM 653 – 6-8" OF TOPSOIL FURNISHED AND PLACED TO 1" ABOVE CURB
ITEM C659 – SEEDING AND MULCHING



CITY OF
CENTERVILLE, OH
PUBLIC WORKS DEPARTMENT
7970 SOUTH SUBURBAN ROAD
CENTERVILLE, OHIO 45458
PHONE (937) 428-4782
FAX (937) 433-0286

C202 & C609 CURB
REPLACEMENT ON
EXISTING EXPOSED
CONCRETE ROADWAY

Approval:
JAMES G. BRINEGAR
James Brinegar
City Engineer

Date: Jan. 2018
Revision: Jan. 2021

SHEET
3

NOTES:

1. SAW CUT & REMOVE EXISTING PAVEMENT AS MARKED.
2. REMOVE EXISTING PAVEMENT AND EXCAVATE TO A TOTAL OF 12" DEPTH, OR MATCH EXISTING IF GREATER THAN 12"
3. DO NOT DISTURB OR UNDERMINE ADJACENT PAVEMENT.
4. 24" MINIMUM WIDTH.

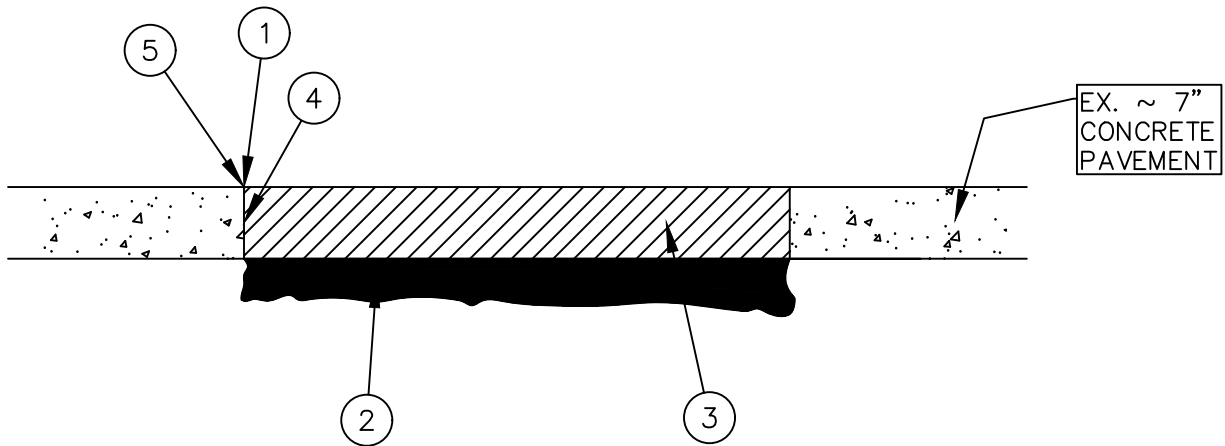

IMPROVEMENT LEGEND

- ① ITEM 202 – REMOVE EXISTING CONCRETE PAVEMENT
ITEM 202 – SAW CUT FULL DEPTH, AS DIRECTED BY ENGINEER
ITEM 203 – EXCAVATION
- ② ITEM 204 – SUBGRADE COMPACTION
ITEM C304 – AGGREGATE BASE, 4" MIN
- ③ ITEM C301 – 8" ASPHALT CONCRETE BASE, COMPACTED IN LIFTS, TO FLUSH WITH ADJACENT PAVEMENT, OR MATCH EXISTING IF GREATER THAN 8"
- ④ SEAL ALL VERTICAL FACES PER ODOT 401.14
- ⑤ ITEM C423 – CRACK SEALING, TYPE II, 4" RIBBON



CITY OF
CENTERVILLE, OH
PUBLIC WORKS DEPARTMENT
7970 SOUTH SUBURBAN ROAD
CENTERVILLE, OHIO 45458
PHONE (937) 428-4782
FAX (937) 433-0286

C252
FULL DEPTH RIGID
PAVEMENT REMOVAL
& FLEXIBLE
REPLACEMENT

Approval:
JAMES G. BRINEGAR
James Brinegar
City Engineer

Date: Jan. 2018
Revision: Jan. 2021

SHEET
4

IT IS THE INTENT OF THIS DRAWING TO SHOW THAT ASPHALT STREET REPAIRS WILL CONSIST OF INTERMITTENT "SPOT CORRECTIONS". IT IS EXPECTED THAT SOME AREAS WILL HAVE LARGE SECTIONS OF PAVEMENT MARKED FOR REMOVAL AND SOME WILL HAVE RATHER SMALL AREAS, WITH A 2' MIN WIDTH.

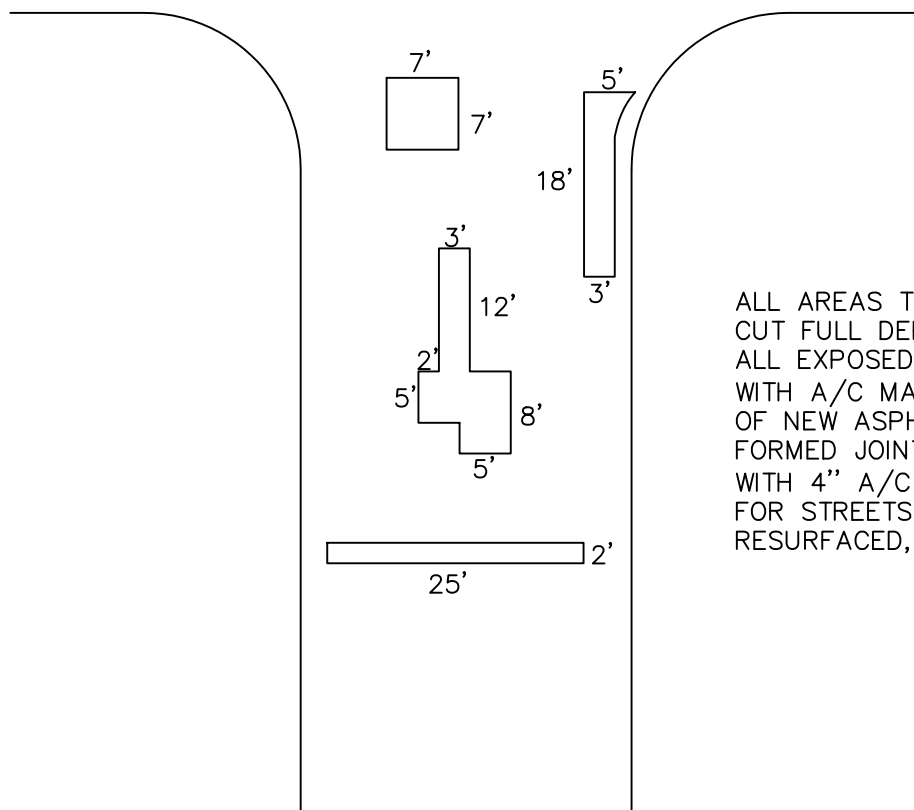

ALL AREAS TO BE REMOVED SHALL BE SAW CUT FULL DEPTH TO PROVIDE CLEAN JOINTS. ALL EXPOSED EDGES SHALL BE TREATED WITH A/C MATERIAL PRIOR TO PLACEMENT OF NEW ASPHALT PER ODOT 401.14. NEWLY FORMED JOINTS SHALL BE CRACK SEALED WITH 4" A/C RIBBON PER ITEM C423 TYPE II, FOR STREETS THAT WILL NOT BE RESURFACED, ONLY.

PAVEMENT REMOVAL AREAS WILL BE MARKED IN THE STREET WITH INSTRUCTIONS GIVEN TO THE CONTRACTOR PRIOR TO THE START OF THE WORK.



CITY OF
CENTERVILLE, OH
PUBLIC WORKS DEPARTMENT
7970 SOUTH SUBURBAN ROAD
CENTERVILLE, OHIO 45458
PHONE (937) 428-4782
FAX (937) 433-0286

C252 FULL DEPTH RIGID
PAVEMENT REMOVAL AND
FLEXIBLE REPLACEMENT
OR
C253 FULL DEPTH
FLEXIBLE PAVEMENT
REPAIR

Approval:
JAMES G. BRINEGAR
James Brinegar
City Engineer

Date: Jan. 2018
Revision: Jan. 2019
SHEET 5

1. SECTION OF DETERIORATING SURFACE PROBLEMS, ALLIGATORING & OTHER SURFACE PROBLEMS.

ASPHALT ROADWAY

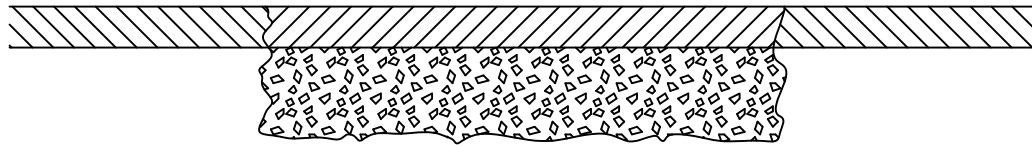

2. SAW CUT PORTION OF ROADWAY AND EXCAVATE FROM TOP OF SURFACE TO MARKED LIMITS.

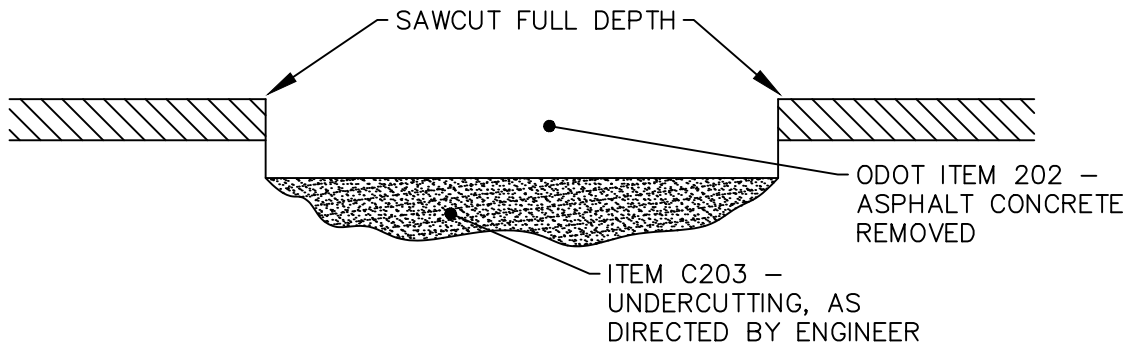

3. BACKFILL AND COMPACT WITH ROLLER OR HAND VIBRATOR MACHINE PER ODOT 204.

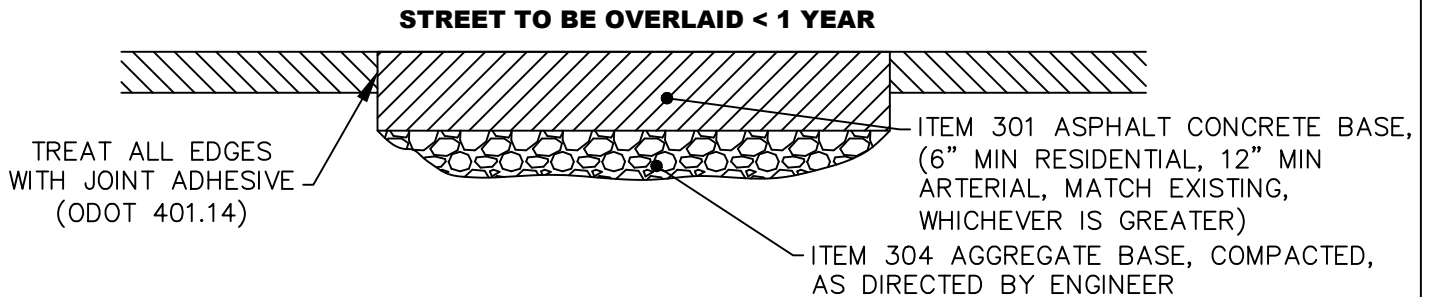
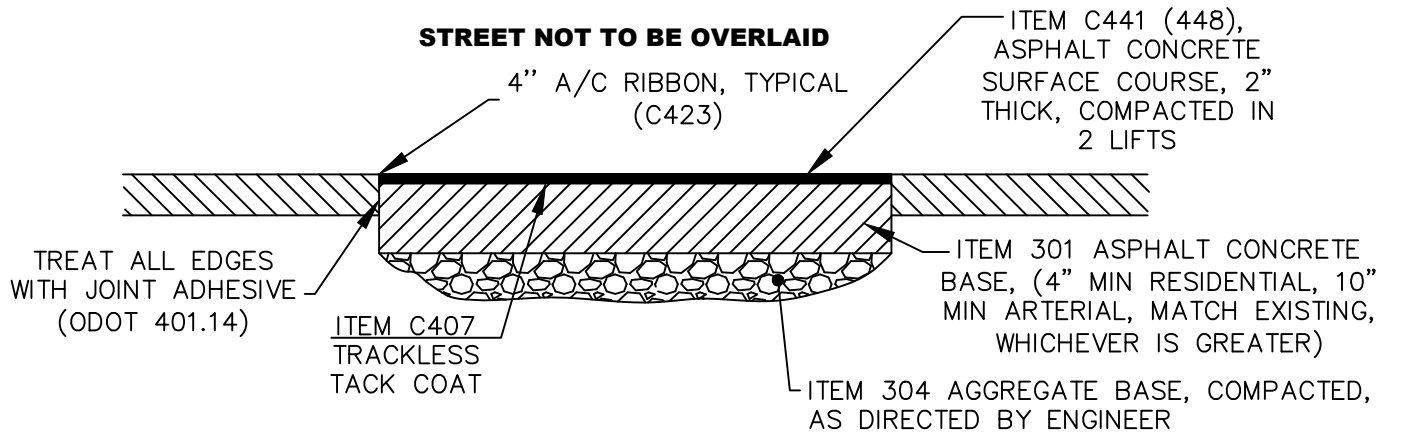

CITY OF
CENTERVILLE, OH
PUBLIC WORKS DEPARTMENT
7970 SOUTH SUBURBAN ROAD
CENTERVILLE, OHIO 45458
PHONE (937) 428-4782
FAX (937) 433-0286

C253
FULL DEPTH
FLEXIBLE PAVEMENT
REPAIR

Approval:
JAMES G. BRINEGAR
James Brinegar
City Engineer

Date: Jan. 2018
Revision: Jan. 2019
SHEET
6

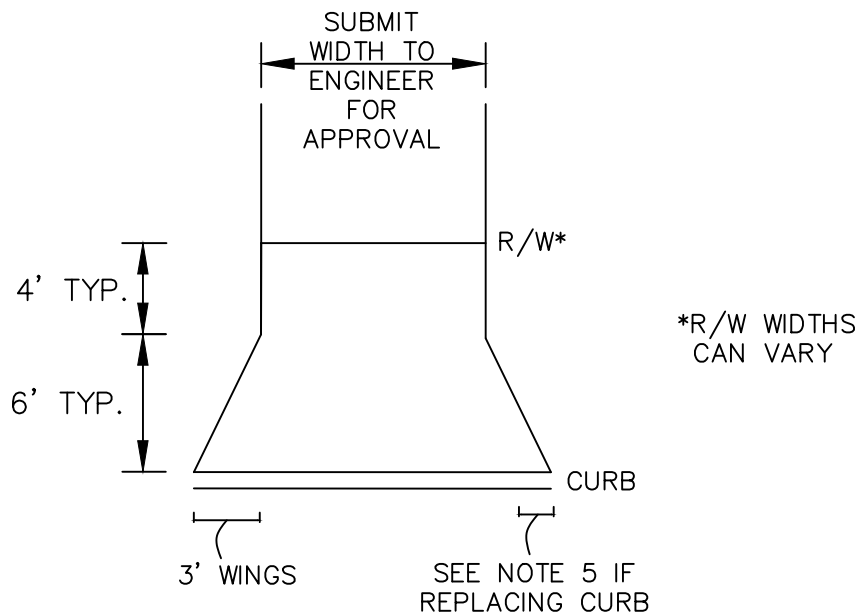
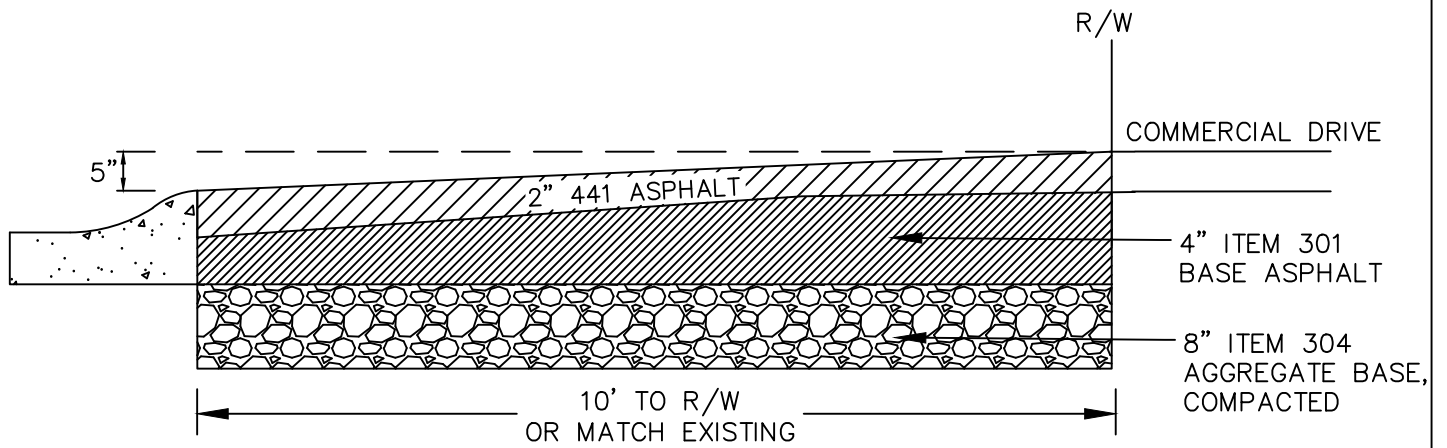

NOTES:

1. PLEASE CALL 937-428-4782 FOR INSPECTION ONE DAY PRIOR TO PLACEMENT OF ASPHALT.
2. ELEVATION AT RIGHT OF WAY IS EQUAL TO $\frac{1}{2}$ " PER 1' ABOVE TOP OF CURB. A TYPICAL DRIVEWAY AT 10' R/W LINE WILL BE 5" ABOVE THE TOP OF STANDARD HEIGHT CURB.
3. TACK COAT BACK OF CURB PER ODOT 401.14 BEFORE ASPHALT IS PLACED.
4. NOTE IF REPLACING CURB: CONTACT INSPECTOR PRIOR TO SAWING CURB. DEPRESSED CURB SHALL BE $1\frac{1}{2}$ " ABOVE THE FLOW LINE OF CURB. 12" HORIZONTAL TRANSITION FOR DEPRESSED CURB.

NOTE: IF STREET HAS CONCRETE WALK, DRIVE APRON MUST BE CONCRETE.



CITY OF
CENTERVILLE, OH
PUBLIC WORKS DEPARTMENT
7970 SOUTH SUBURBAN ROAD
CENTERVILLE, OHIO 45458
PHONE (937) 428-4782
FAX (937) 433-0286

C441
COMMERCIAL
ASPHALT
DRIVE APRON

Approval:
JAMES G. BRINEGAR
James Brinegar
City Engineer

Date: Sept. 2020
Revision: Jan. 2021
SHEET
7

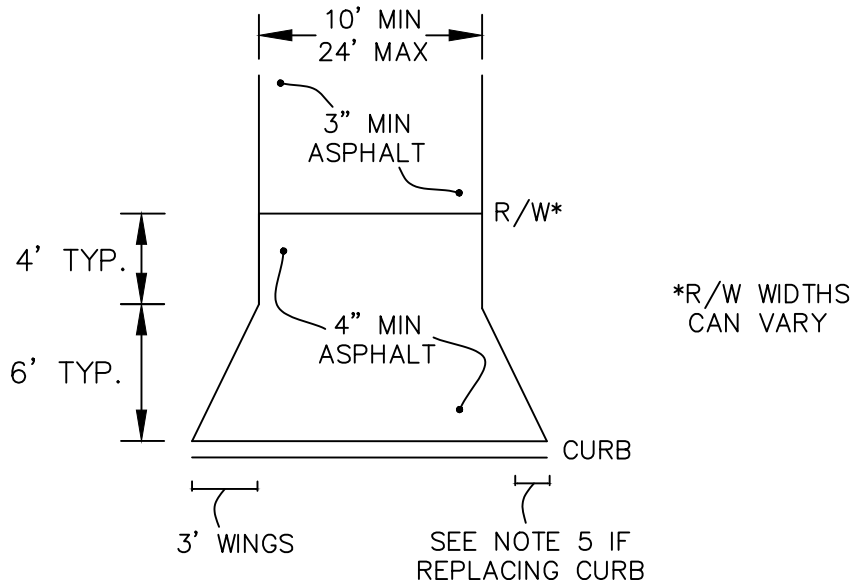
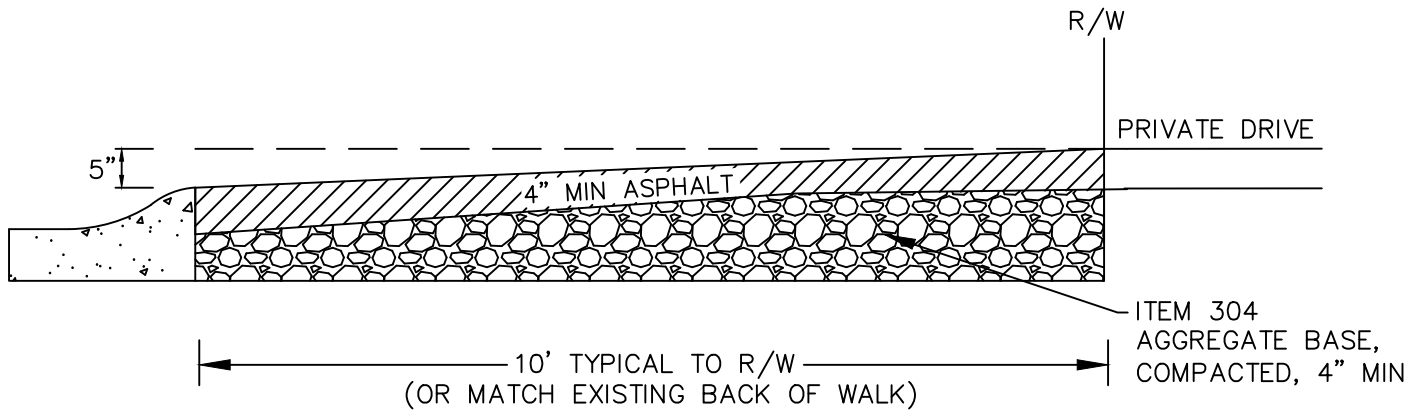

NOTES:

1. PLEASE CALL 937-428-4782 FOR INSPECTION ONE DAY PRIOR TO PLACEMENT OF ASPHALT.
2. ELEVATION AT RIGHT OF WAY IS EQUAL TO 1/2" PER 1' ABOVE TOP OF CURB. A TYPICAL DRIVEWAY AT 10' R/W LINE WILL BE 5" ABOVE THE TOP OF STANDARD HEIGHT CURB.
3. TACK COAT BACK OF CURB PER ODOT 401.14 BEFORE ASPHALT IS PLACED.
4. IF STREET HAS CONCRETE WALK, DRIVE APRON MUST BE CONCRETE.
5. NOTE IF REPLACING CURB: CONTACT INSPECTOR PRIOR TO SAWING CURB. DEPRESSED CURB SHALL BE 1 1/2" ABOVE THE FLOW LINE OF CURB. 12" HORIZONTAL TRANSITION FOR DEPRESSED CURB.



CITY OF
CENTERVILLE, OH
PUBLIC WORKS DEPARTMENT
7970 SOUTH SUBURBAN ROAD
CENTERVILLE, OHIO 45458
PHONE (937) 428-4782
FAX (937) 433-0286

C441
RESIDENTIAL
ASPHALT DRIVE
APRON

Approval:
JAMES G. BRINEGAR
James Brinegar
City Engineer

Date: Jan. 2018
Revision: April 2020

SHEET
8

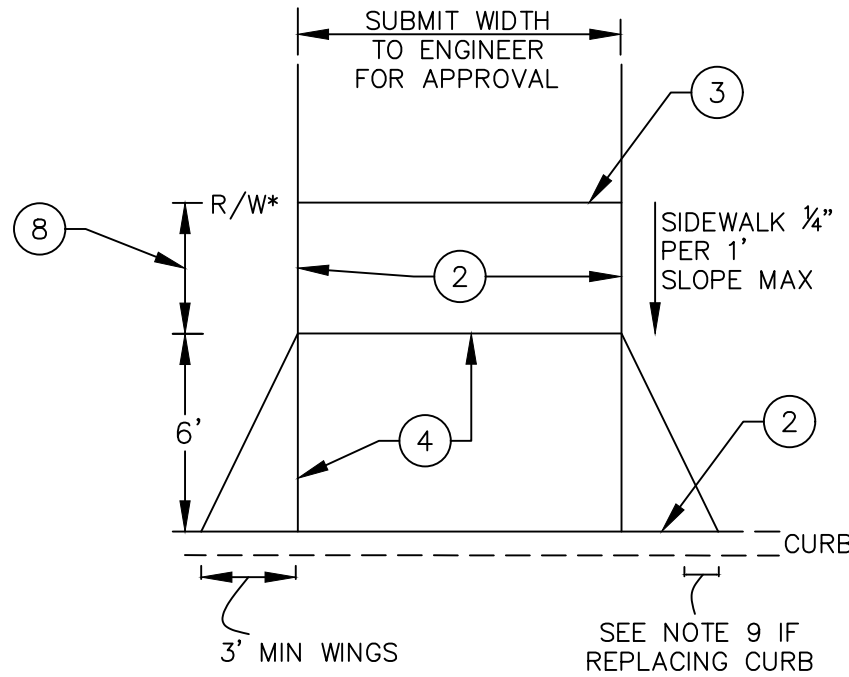
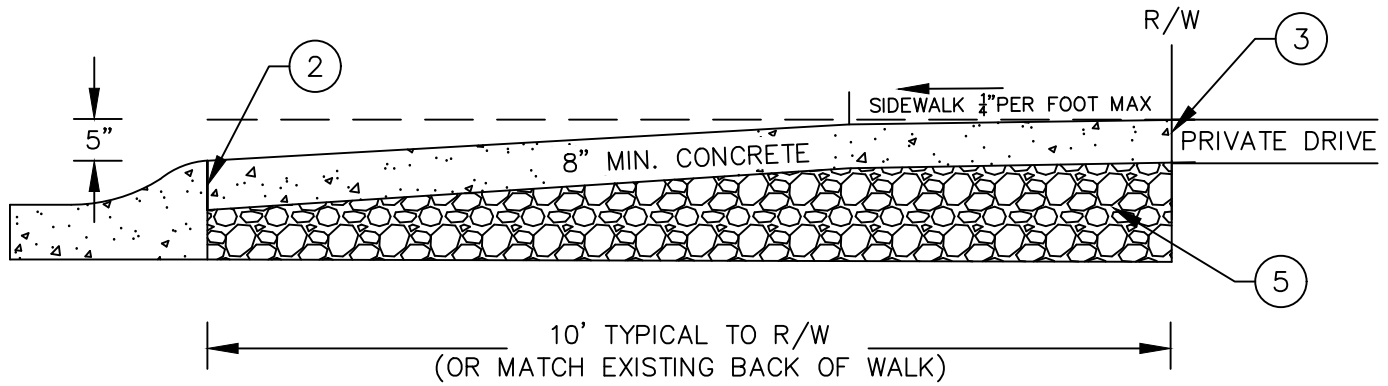

*R/W WIDTHS CAN VARY

NOTES:

1. SET ELEVATION AT BACK OF WALK AT $\frac{1}{4}$ " PER FOOT ABOVE THE TOP OF STANDARD CURB. A TYPICAL DRIVEWAY AT THE BACK OF WALK WILL BE 5" ABOVE THE TOP OF STANDARD CURB HEIGHT.
2. FULL-DEPTH 8" VINYL EXPANSION MATERIAL $\frac{1}{2}$ " THICK REQUIRED.
3. 4" VINYL EXPANSION MATERIAL TO MATCH CONCRETE THICKNESS BEHIND RIGHT OF WAY. IF ASPHALT BEHIND RIGHT OF WAY, EXPANSION NOT NEEDED.
4. TOOLED CONTRACTION JOINT - ALL JOINTS SHALL BE $\frac{1}{2}$ TOOLED JOINTS WITH LIGHT RETRACE (SAW JOINTS PROHIBITED).
5. ITEM 304 COMPACTED SUBGRADE AND 4" OF AGGREGATE BASE SHALL BE PLACED UNDER DRIVE APPROACH. NO SLAG USE FOR BASE.
6. ALL EXPOSED SURFACES SHALL BE BROOMED AND EDGED. CURING COMPOUND SHALL BE APPLIED ON ALL FINISHED CONCRETE IN R/W PER ITEM 451.11.
7. FOR TREE LAWNS OF LESS THAN 6 FEET IN WIDTH, CALL INSPECTOR PRIOR TO REMOVAL
8. SIDEWALK CAN VARY IN WIDTH DEPENDING ON EXISTING CONDITIONS (4', 5', 8').
9. NOTE IF REPLACING CURB: CONTACT INSPECTOR PRIOR TO SAWING CURB. TOP OF DEPRESSED CURB SHALL BE $1\frac{1}{2}$ " ABOVE THE FLOW LINE OF CURB. 12" HORIZONTAL TRANSITION FOR DEPRESSED CURB. CURB AND DRIVEWAY SHALL BE POURED SEPARATELY.
10. MUST USE SAW CAPABLE OF FULL-DEPTH CUT THROUGH CURB



CITY OF
 CENTERVILLE, OH
 PUBLIC WORKS DEPARTMENT
 7970 SOUTH SUBURBAN ROAD
 CENTERVILLE, OHIO 45458
 PHONE (937) 428-4782
 FAX (937) 433-0286

C452 COMMERCIAL
 CONCRETE DRIVE
 APRON

Approval:
JAMES G. BRINEGAR
 James Brinegar
 City Engineer

Date: Sept. 2020
 Revision: Jan. 2021
 SHEET
 9

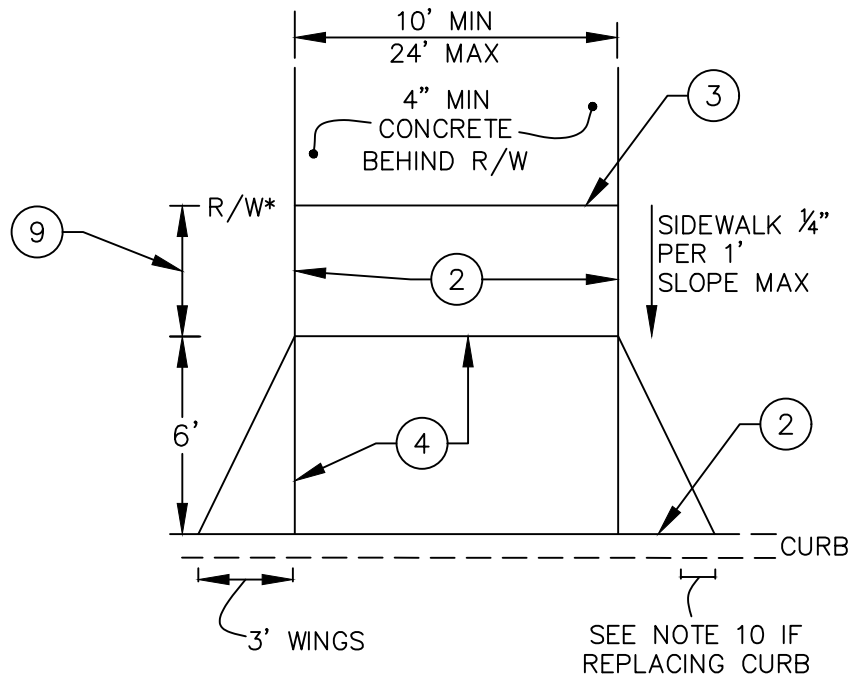
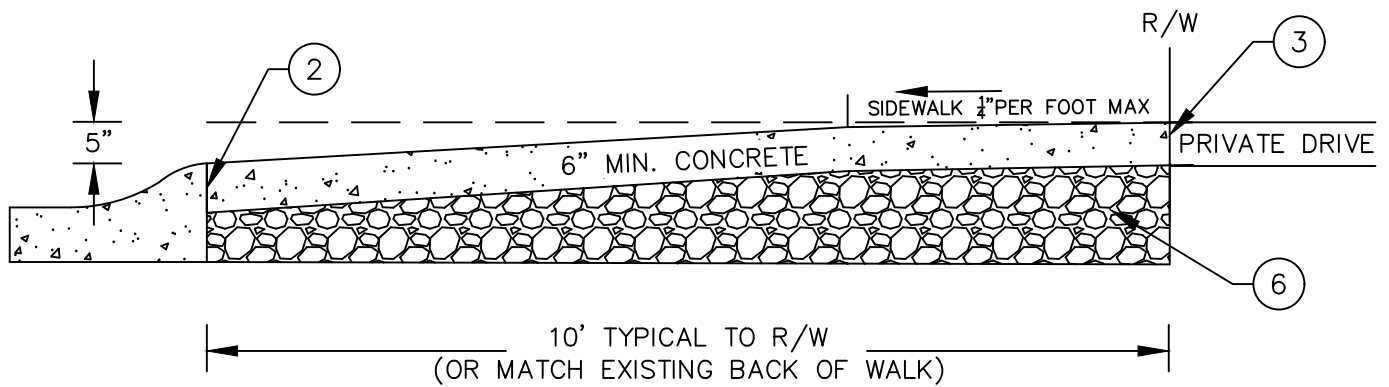

*R/W WIDTHS CAN VARY

NOTES:

1. SET ELEVATION AT BACK OF WALK AT $\frac{1}{2}$ " PER FOOT ABOVE THE TOP OF STANDARD CURB. A TYPICAL DRIVEWAY AT THE BACK OF WALK WILL BE 5" ABOVE THE TOP OF STANDARD CURB HEIGHT.
2. FULL-DEPTH 6" VINYL EXPANSION MATERIAL $\frac{1}{2}$ " THICK REQUIRED. 6" DEEP AT CURB.
3. 4" VINYL EXPANSION MATERIAL
4. TOOLED CONTRACTION JOINT – ALL JOINTS SHALL BE $\frac{1}{2}$ TOOLED JOINTS WITH LIGHT RETRACE (SAW JOINTS PROHIBITED).
5. MINIMUM 6" THICK CONCRETE RESIDENTIAL DRIVE APPROACH ITEM C452 QC MISC OR QC 1 MIX IN R/W. 8" MINIMUM FOR COMMERCIAL.
6. ITEM 304 COMPACTED SUBGRADE AND 4" OF AGGREGATE BASE SHALL BE PLACED UNDER DRIVE APPROACH. NO SLAG USE FOR BASE.
7. ALL EXPOSED SURFACES SHALL BE BROOMED AND EDGED. CURING COMPOUND SHALL BE APPLIED ON ALL FINISHED CONCRETE IN R/W PER ITEM 451.11.
8. FOR TREE LAWNS OF LESS THAN 6 FEET IN WIDTH, CALL INSPECTOR PRIOR TO REMOVAL
9. SIDEWALK CAN VARY IN WIDTH DEPENDING ON EXISTING CONDITIONS (4', 5', 8').
10. NOTE IF REPLACING CURB: CONTACT INSPECTOR PRIOR TO SAWING CURB. TOP OF DEPRESSED CURB SHALL BE $1\frac{1}{2}$ " ABOVE THE FLOW LINE OF CURB. 12" HORIZONTAL TRANSITION FOR DEPRESSED CURB. CURB AND DRIVEWAY SHALL BE POURED SEPARATELY.



CITY OF
CENTERVILLE, OH
PUBLIC WORKS DEPARTMENT
7970 SOUTH SUBURBAN ROAD
CENTERVILLE, OHIO 45458
PHONE (937) 428-4782
FAX (937) 433-0286

C452
RESIDENTIAL
CONCRETE DRIVE
APRON

Approval:
JAMES G. BRINEGAR
James Brinegar
City Engineer

Date: Jan. 2018
Revision: April 2020

SHEET
10

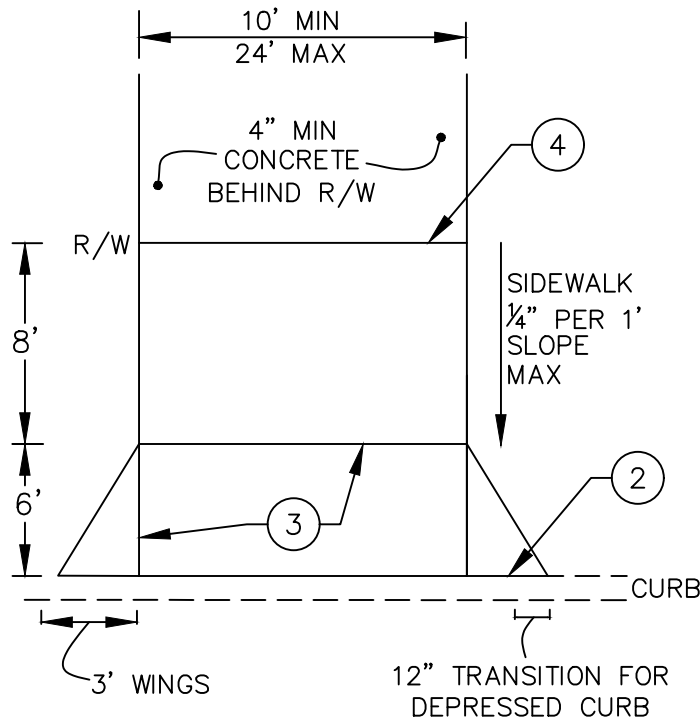
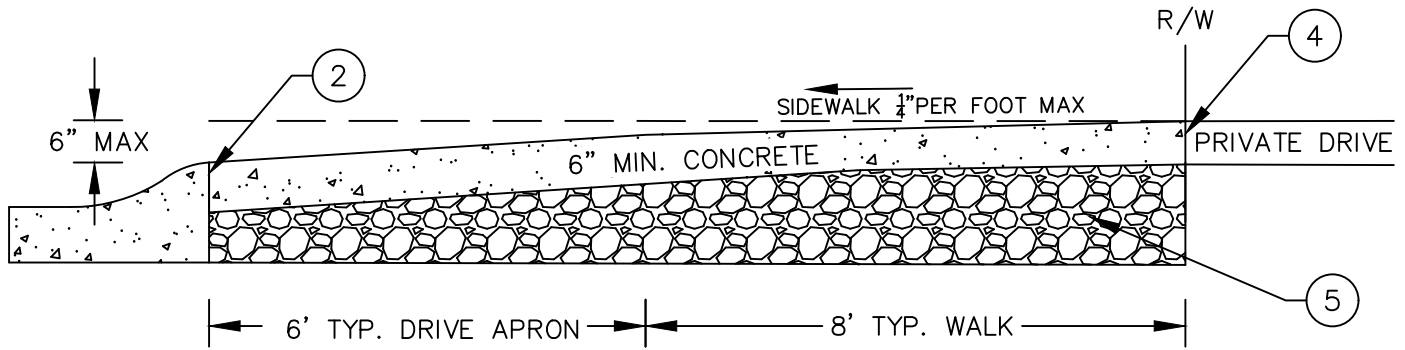

NOTES:

1. CONCRETE DRIVE WITH OR WITHOUT SIDEWALK WITHIN PUBLIC RIGHT-OF-WAY SHALL HAVE 6" THICK CONCRETE QC MISC. MIX. CURING COMPOUND REQUIRED WITHIN RIGHT-OF-WAY IN ACCORDANCE WITH ITEM 451.11. 8" MINIMUM FOR COMMERCIAL DRIVES.
2. 6" VINYL EXPANSION MATERIAL 1/2" THICK REQUIRED. 6" DEEP AT CURB.
3. TOOLED CONTRACTION JOINT - MINIMUM JOINT DEPTH 1/2" TOOLED JOINTS WITH LIGHT RETRACE.
4. 4" VINYL EXPANSION MATERIAL
5. ITEM 304 COMPACTED SUBGRADE AND 4" OF 304 BASE SHALL BE PLACED UNDER THE DRIVE APPROACH. NO SLAG USE ALLOWED.
6. ALL EXPOSED SURFACES SHALL BE BROOMED AND EDGED WITH LIGHT RETRACE.
7. BACK OF WALK ELEVATION IS EQUAL TO 1/2" PER FOOT ABOVE TOP OF CURB. (MAX 6" ABOVE TOP OF CURB.)



CITY OF
CENTERVILLE, OH
PUBLIC WORKS DEPARTMENT
7970 SOUTH SUBURBAN ROAD
CENTERVILLE, OHIO 45458
PHONE (937) 428-4782
FAX (937) 433-0286

YANKEE TRACE
DRIVE APRON

Approval:

JAMES G. BRINEGAR
James Brinegar
City Engineer

Date: April 2020

Revision: April 2020

SHEET
11

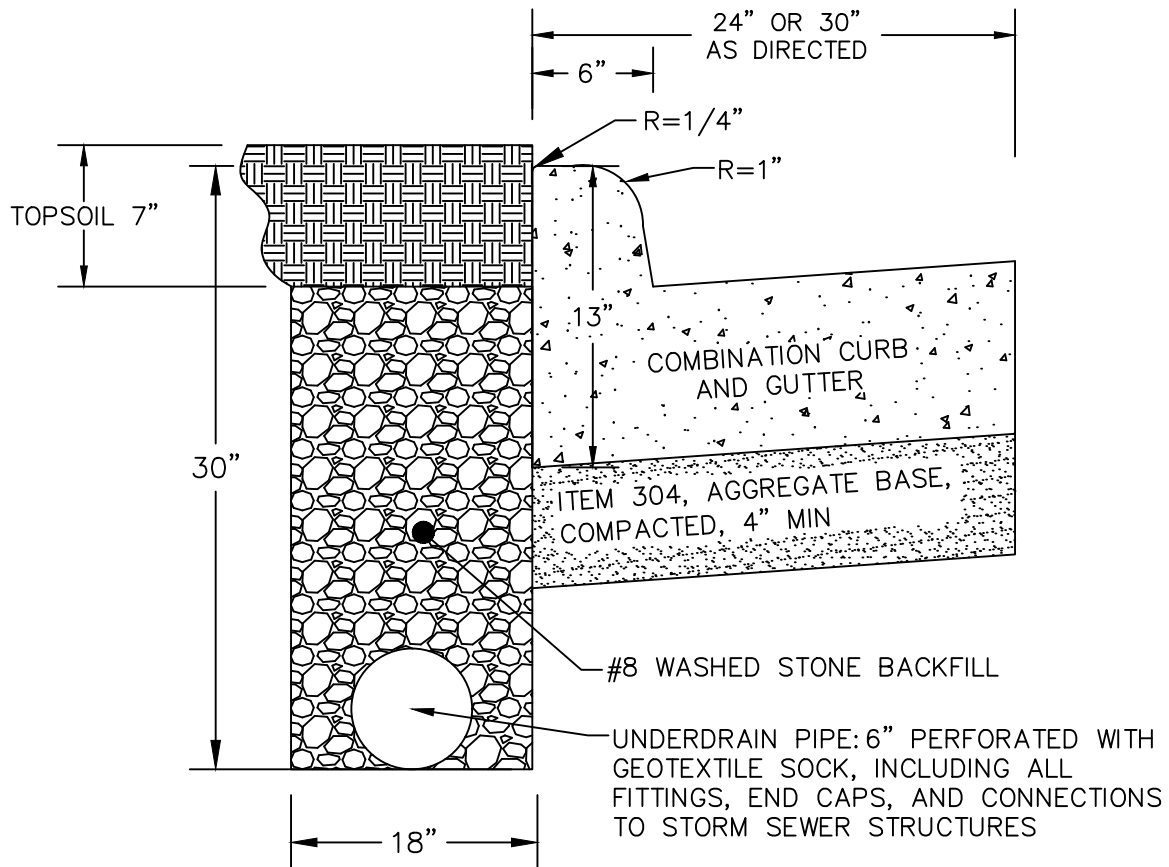

NOTES:

1. IF SPECIFIED 4" PIPE, USE 12" TRENCH WIDTH, ONLY AS DIRECTED BY CITY ENGINEER.
2. TOPSOIL SHALL BE PLACED TO 1" ABOVE THE CURB



CITY OF
CENTERVILLE, OH
PUBLIC WORKS DEPARTMENT
7970 SOUTH SUBURBAN ROAD
CENTERVILLE, OHIO 45458
PHONE (937) 428-4782
FAX (937) 433-0286

C605
UNDERDRAIN

Approval:

JAMES G. BRINEGAR
James Brinegar
City Engineer

Date: Jan. 2018

Revision: Jan. 2019

SHEET
12

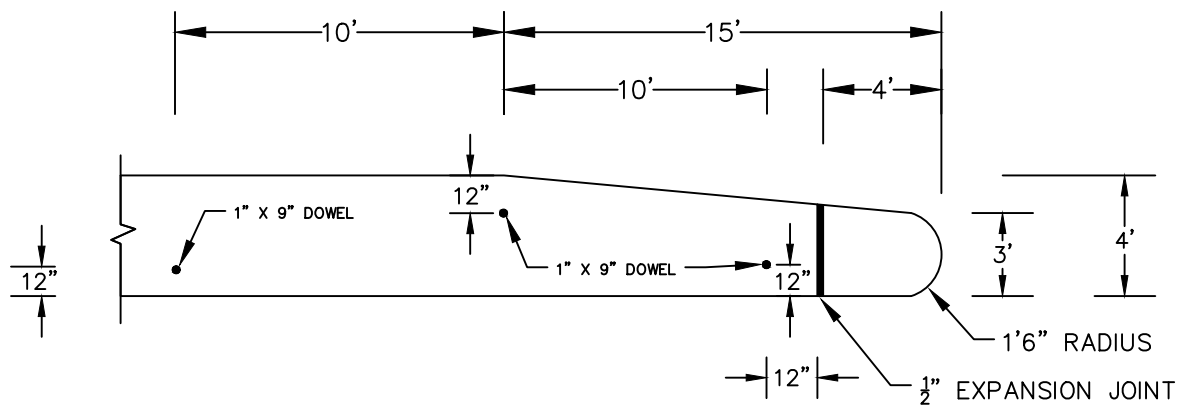

TOP VIEW

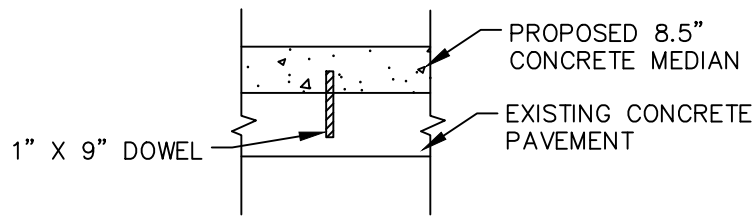

DOWEL DETAIL

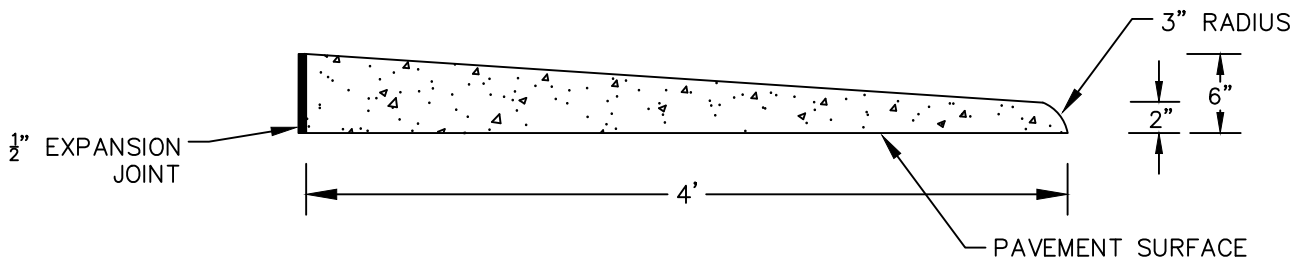

MEDIAN NOSE SIDE VIEW

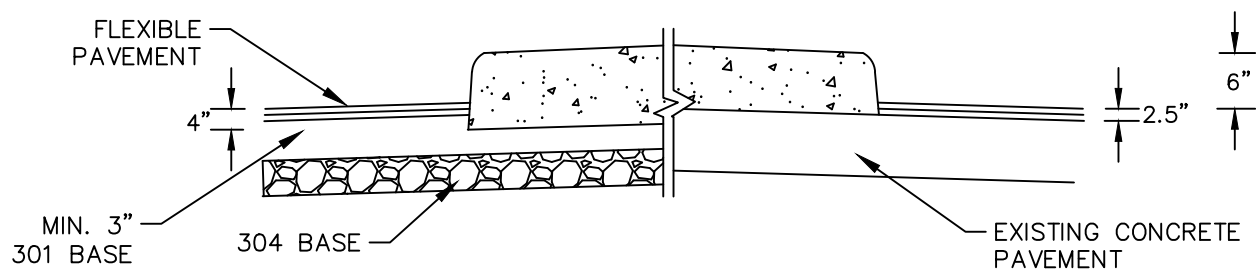

CROSS SECTION



CITY OF
CENTERVILLE, OH
PUBLIC WORKS DEPARTMENT
7970 SOUTH SUBURBAN ROAD
CENTERVILLE, OHIO 45458
PHONE (937) 428-4782
FAX (937) 433-0286

C609 -
CONCRETE MEDIAN

Approval:
JAMES G. BRINEGAR
James Brinegar
City Engineer

Date: Jan. 2023

Revision:

SHEET
13

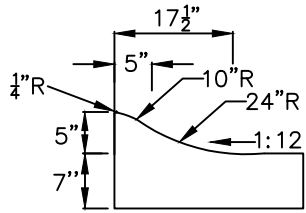

TYPE "3-A"
INTEGRAL ROLL CURB

- NOTE:
1. USE IN RESIDENTIAL AREAS ON LOCAL STREETS.
 2. TRANSVERSE PAVEMENT JOINTS SHALL BE EXTENDED THRU THE CURB.
- * INTEGRAL WITH CONCRETE PAVEMENT

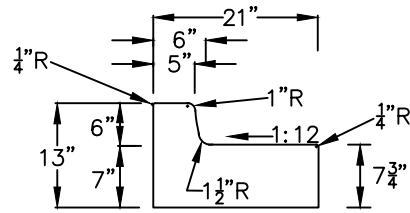

TYPE "2"
COMBINED CURB & GUTTER

- NOTE:
1. USE WITH ALL ASPHALT PAVEMENTS.
 2. 1/2" PREMOLDED EXPANSION JOINTS SHALL BE CONSTRUCTED EACH SIDE OF DRIVE APPROACH SECTIONS, BOTH SIDES OF CATCH BASINS, AND AT P.C. POINTS AT INTERSECTIONS, BUT THE MAXIMUM SPACING SHALL NOT EXCEED 100'.

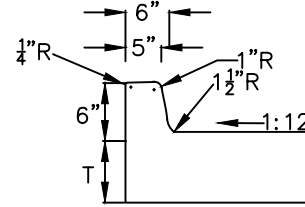

TYPE "2-A"
INTEGRAL CURB & GUTTER

- NOTE:
1. USE IN BUSINESS AND INDUSTRIAL AREAS.
 2. TRANSVERSE PAVEMENT JOINTS SHALL BE EXTENDED THRU THE CURB.
 3. T=EXISTING PAVEMENT THICKNESS, BUT NOT LESS THAN 7"

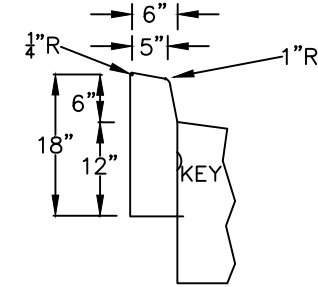

TYPE "6"
BARRIER CURB

- NOTE:
1. USE AROUND MEDIANS SECTIONS AND ON THOROUGHFARES.
 2. WHEN USED WITH CONCRETE PAVEMENTS, CURB SHALL BE KEYED AND NOT BE INTEGRALLY POURED.

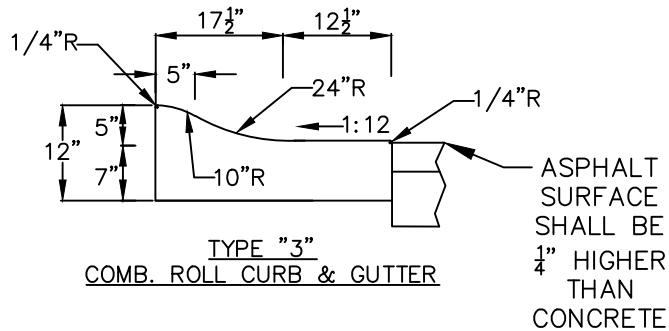

TYPE "3"
COMB. ROLL CURB & GUTTER

- NOTES:
1. USE IN RESIDENTIAL AREAS WITH ASPHALT PAVEMENTS ON LOCAL STREETS ONLY.
 2. 1/2" PREMOLDED EXPANSION JOINTS SHALL BE CONSTRUCTED EACH SIDE OF DRIVE APPROACH SECTIONS AND AT P.C. POINTS AT INTERSECTIONS, BUT THE MAXIMUM SPACING SHALL NOT EXCEED 100'.

NOTES:

1. CURBING SHALL MEET THE REQUIREMENTS SET FORTH IN SUPPLEMENTAL SPECIFICATION FOR ITEM C609, CURBING.
2. WHEN USED WITH ASPHALT PAVEMENTS, TYPE 2, 3, & 6 CURBING SHALL HAVE CONTRACTION JOINTS EVERY 5'. WHEN TYPE 6 CURBING IS USED WITH CONCRETE PAVEMENTS, CONTRACTION JOINTS SHALL BE PLACED OPPOSITE CONTRACTION JOINTS IN THE PAVEMENT.
3. CURBING SHALL BE BACKFILLED IMMEDIATELY AFTER FORMS ARE REMOVED. BACKFILL SHALL BE CLEAN OF DEBRIS AND TRASH.
4. PROVIDE BROOM FINISH AND EDGING TO ALL EXPOSED SURFACES.
5. CURING COMPOUND SHALL BE APPLIED ON ALL FINISHED CONCRETE IN R/W IN ACCORDANCE WITH ASTM C309.
6. CONTINUOUS MACHINED CURB SHALL BE PLACED IN SECTIONS OF 150 LF OR GREATER.
7. MACHINE CURB SHOE SHALL BE APPROVED BY CITY ENGINEER PRIOR TO CONCRETE PLACEMENT.
8. NO DEDUCTIONS SHALL BE MADE FOR DEPRESSED CURB AT DRIVEWAYS, CURB RAMPS OR CATCH BASINS.
9. "SPILL CURB" SHALL BE CONSIDERED IN AREAS OF NON-STANDARD ROADWAY CROWN, AS DIRECTED BY CITY ENGINEER.

Date: Jan. 2018

Revision: Jan. 2019

SHEET
14

Approval:

JAMES E. BRINEGAR
James Brinegar
City Engineer

C609
CURB

CITY OF
CENTERVILLE, OH
PUBLIC WORKS DEPARTMENT
7970 SOUTH SUBURBAN ROAD
CENTERVILLE, OHIO 45458
PHONE (937) 428-4782
FAX (937) 433-0286



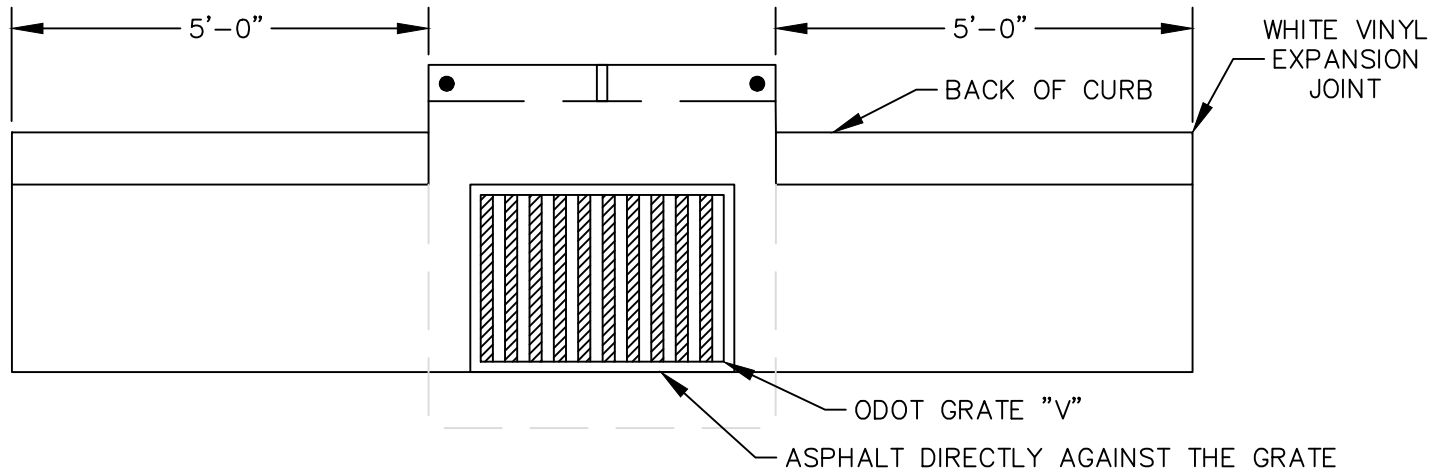

GUTTER TRANSITION AT CATCH BASIN DETAIL

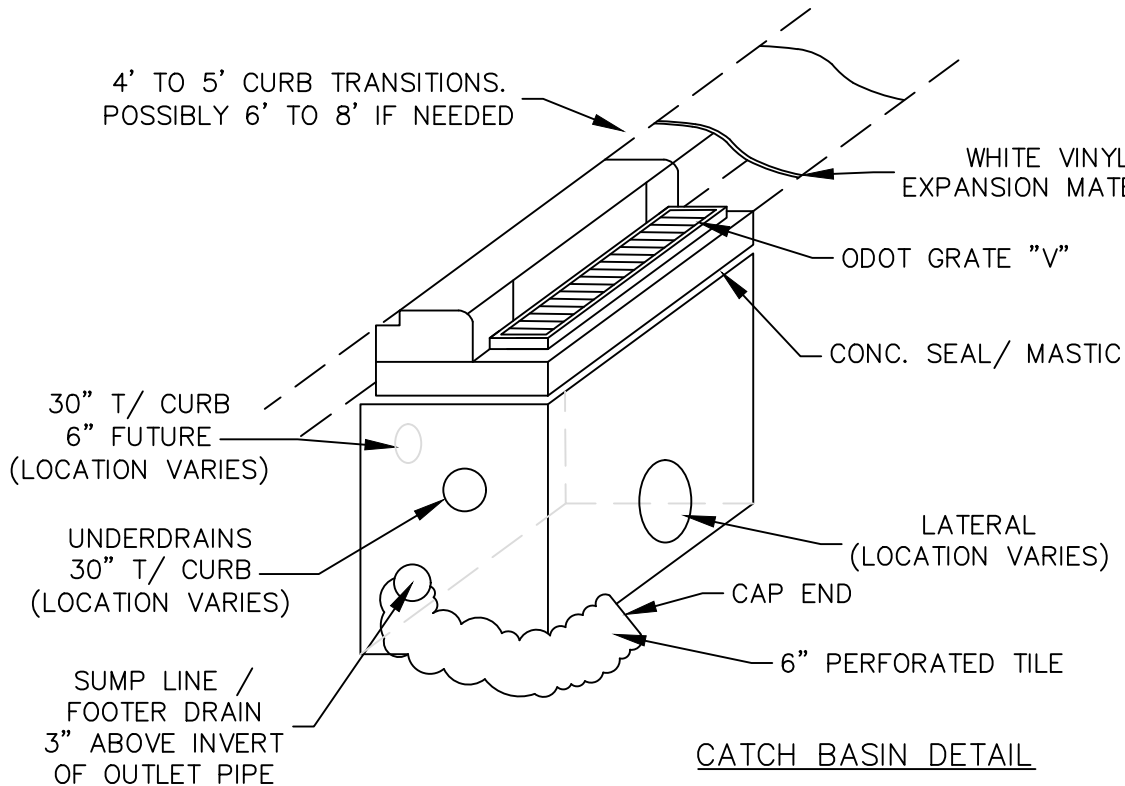

CATCH BASIN DETAIL

NOTE:
 ALL STORM STRUCTURES WITH A GRATED LID INSTALLED, REPAIRED, OR REBUILT SHALL INCLUDE A 4" OR 6" PERFORATED SUMP LINE/CONDUIT THAT INLETS INTO THE BOTTOM OF THE STRUCTURE FOR ADDITIONAL DRAINAGE, AS WELL AS THE PLACEMENT OF A 4" OR 6" PVC SLEEVE FOR FUTURE USE AND/OR TYING IN PRIVATE DRAINAGE LINES. IN ADDITION, CONDUIT SHALL BE INSTALLED WHERE NEEDED AT STRUCTURES TO PREVENT RUNOFF FROM PONDING WITHIN THE STREET DURING CONSTRUCTION (AS APPROVED BY THE CITY ENGINEER). THIS ITEM SHALL BE INCLUDED IN THE PRICE FOR EACH STRUCTURE UNDER ITEM 811.

Approval: <i>JAMES G. BRINEGAR</i> James Brinegar City Engineer	Date: Jan. 2020
	Revision: Jan. 2020
C811 - CATCH BASIN	SHEET 15
CITY OF CENTERVILLE, OH PUBLIC WORKS DEPARTMENT 7970 SOUTH SUBURBAN ROAD CENTERVILLE, OHIO 45458 PHONE (937) 428-4782 FAX (937) 433-0286	

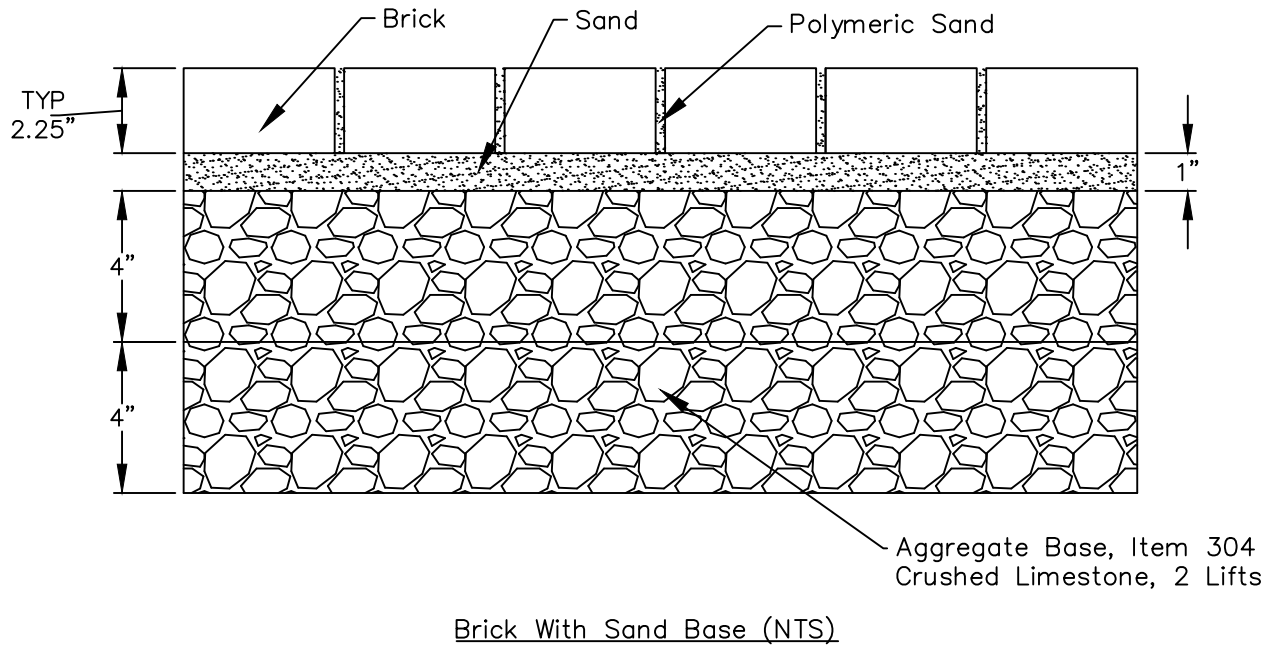
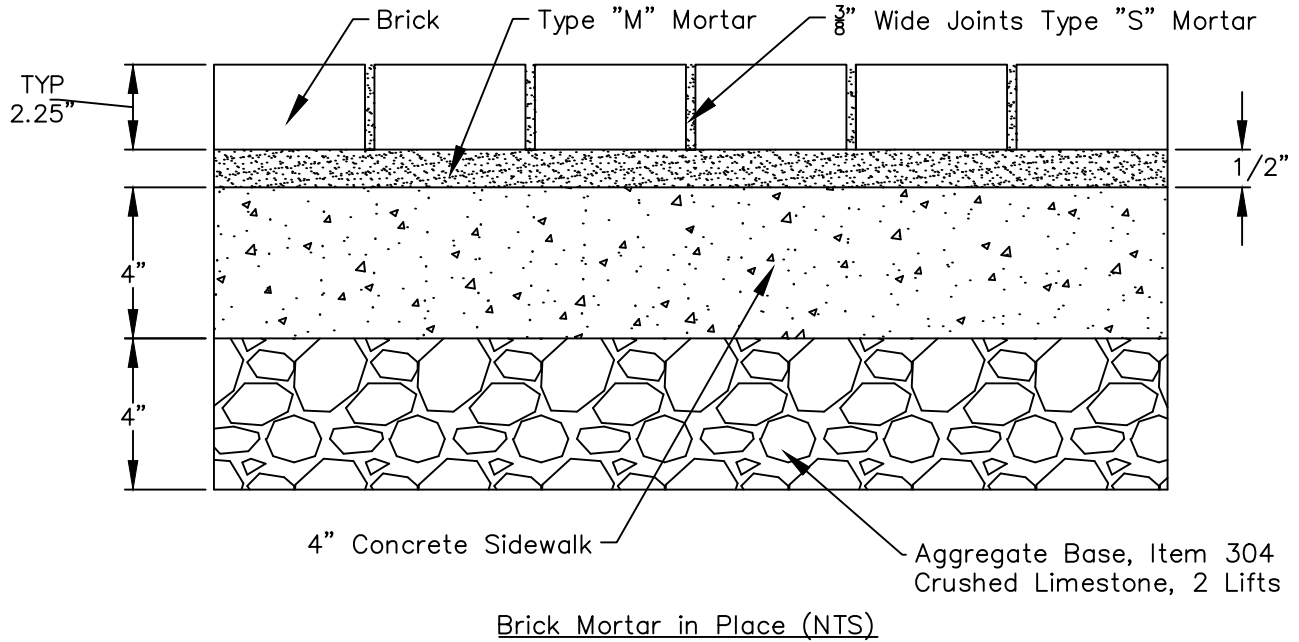

The City utilizes Pine Hall Pathway Full Range brick paver, size 4"x8"x2.25".



CITY OF
CENTERVILLE, OH
PUBLIC WORKS DEPARTMENT
7970 SOUTH SUBURBAN ROAD
CENTERVILLE, OHIO 45458
PHONE (937) 428-4782
FAX (937) 433-0286

BRICK
SIDEWALK

Approval:
JAMES G. BRINEGAR
James Brinegar
City Engineer

Date: July 2014
Revision: Jan. 2020

SHEET
16

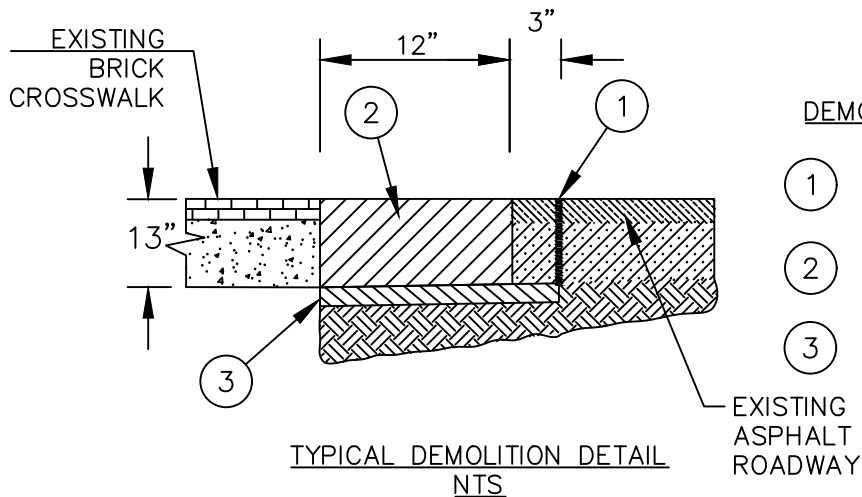

DEMOLITION LEGEND

- ① SAW CUT EXISTING PAVEMENT (FULL DEPTH) 3" IN FRONT OF CONCRETE HEADER
- ② SPECIAL - CONCRETE CROSSWALK HEADER REMOVED
- ③ ITEM 203 - EXCAVATION, 4"

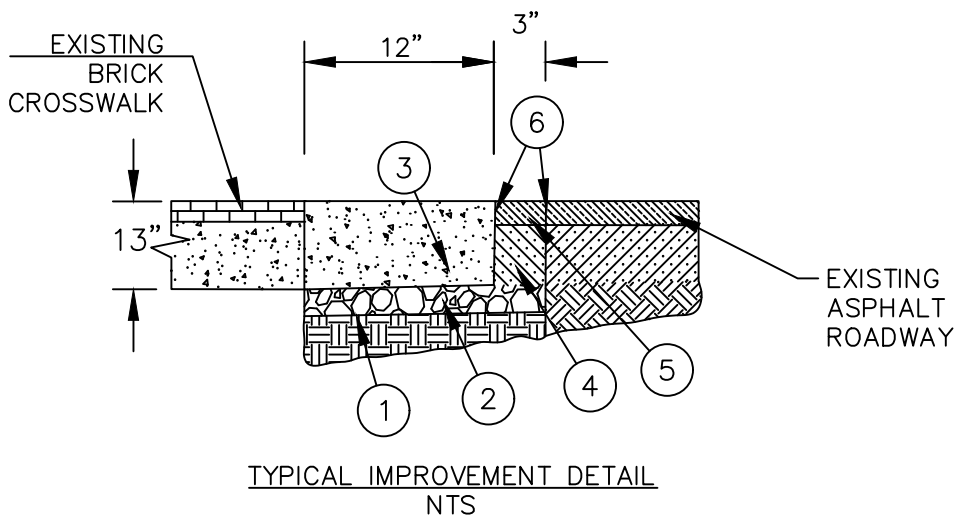

IMPROVEMENT LEGEND

- ① ITEM 204 - SUBGRADE COMPACTION
- ② ITEM 304 - AGGREGATE BASE, 4"
- ③ SPECIAL - CONCRETE CROSSWALK HEADER, REPLACED
- ④ ITEM 613 - LOW STRENGTH MORTAR BACKFILL 100 PSI, 2" BELOW SURFACE
- ⑤ ITEM C441 - TYPE I ASPHALT CONCRETE SURFACE COURSE (448), MEDIUM TRAFFIC, PG64-22, 2" THICK, PLACED IN 2 LIFTS
- ⑥ SEAL ALL VERTICAL FACES PER ODOT 401.14 AND SURFACE JOINTS WITH 4" AC RIBBON



CITY OF
CENTERVILLE, OH
PUBLIC WORKS DEPARTMENT
7970 SOUTH SUBURBAN ROAD
CENTERVILLE, OHIO 45458
PHONE (937) 428-4782
FAX (937) 433-0286

SPECIAL
CONCRETE
CROSS WALK
HEADERS

Approval:
JAMES G. BRINEGAR
James Brinegar
City Engineer

Date: Jan. 2019

Revision:

SHEET
17

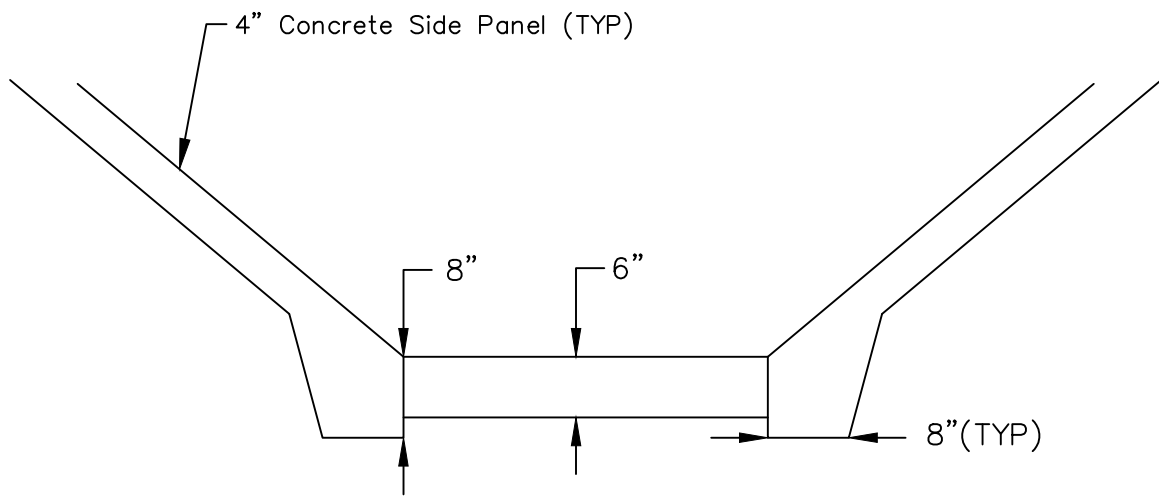

CITY OF
CENTERVILLE, OH
PUBLIC WORKS DEPARTMENT
7970 SOUTH SUBURBAN ROAD
CENTERVILLE, OHIO 45458
PHONE (937) 428-4782
FAX (937) 433-0286

CONCRETE DITCH
AND SIDE PANEL
KEY DETAIL

Approval:
JAMES G. BRINEGAR
James Brinegar
City Engineer

Date: Jan. 2022
Revision:
SHEET 18

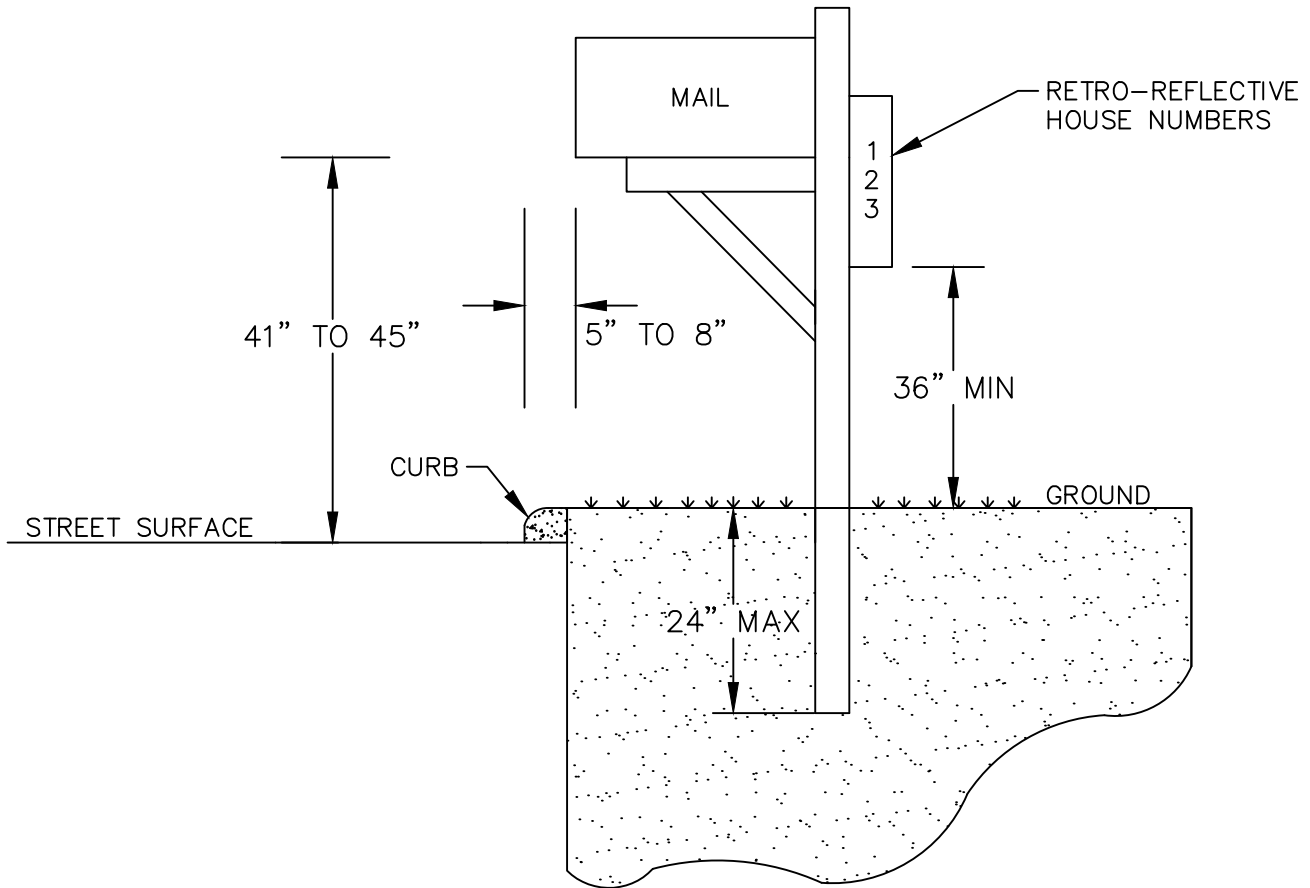

NOTES:

1. USE A WOODEN MAILBOX SUPPORT NO BIGGER THAN 4"X4"
2. USE A 2" DIAMETER STANDARD STEEL OR ALUMINUM PIPE
3. DO NOT USE HEAVY METAL PIPES, CONCRETE POSTS, OR FARM EQUIPMENT
4. IN AREAS WITH LOTS OF SNOW, USE A SEMI-ARCH OR EXTENDED ARM-TYPE SUPPORT. THIS ALLOWS SNOW PLOWS TO SWEEP UNDER WITHOUT KNOCKING IT DOWN.
5. ROUTINE MAILBOX CHECK-UP EVERY SPRING SHOULD INCLUDE:
 - REPLACE LOOSE HINGES ON THE DOOR
 - REPAINT RUSTY OR PEELING PARTS
 - REMOUNT THE POST IF LOOSE
 - REPLACE MISSING OR FADED HOUSE NUMBERS



CITY OF
CENTERVILLE, OH
PUBLIC WORKS DEPARTMENT
7970 SOUTH SUBURBAN ROAD
CENTERVILLE, OHIO 45458
PHONE (937) 428-4782
FAX (937) 433-0286

MAILBOX
CONSTRUCTION
GUIDELINES

Approval:

JAMES G. BRINEGAR
James Brinegar
City Engineer

Date: July 2020

Revision:

SHEET
19

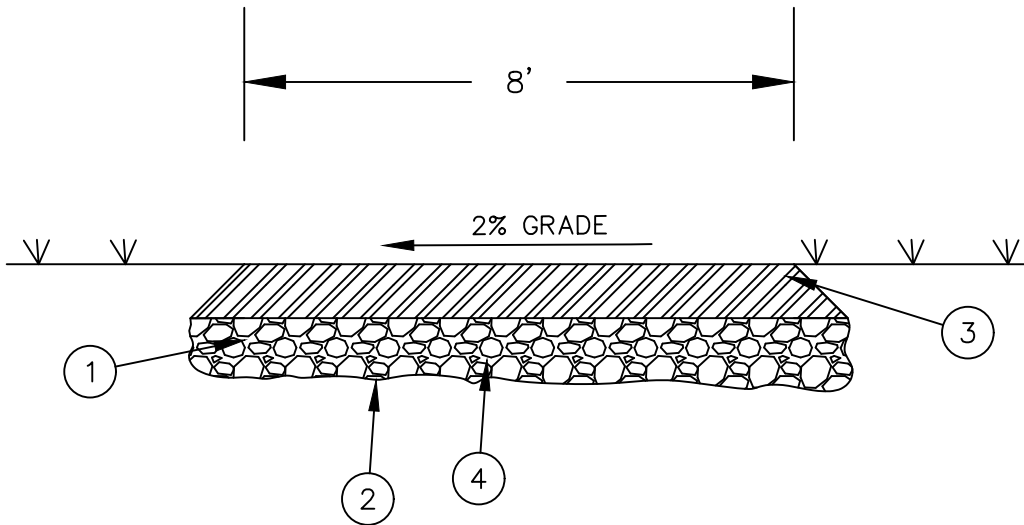

IMPROVEMENT LEGEND

- ① ITEM 203 – EXCAVATION
- ② ITEM 204 – SUBGRADE COMPACTION
- ③ ITEM C441 – 1½" ASPHALT CONCRETE SURFACE COURSE
- ④ ITEM C304 – AGGREGATE BASE, 6" MIN



CITY OF
 CENTERVILLE, OH
 PUBLIC WORKS DEPARTMENT
 7970 SOUTH SUBURBAN ROAD
 CENTERVILLE, OHIO 45458
 PHONE (937) 428-4782
 FAX (937) 433-0286

MULTI-USE TRAIL –
 YANKEE TRACE

Approval:
JAMES G. BRINEGAR
 James Brinegar
 City Engineer

Date: Sept. 2020

Revision:

SHEET
 20

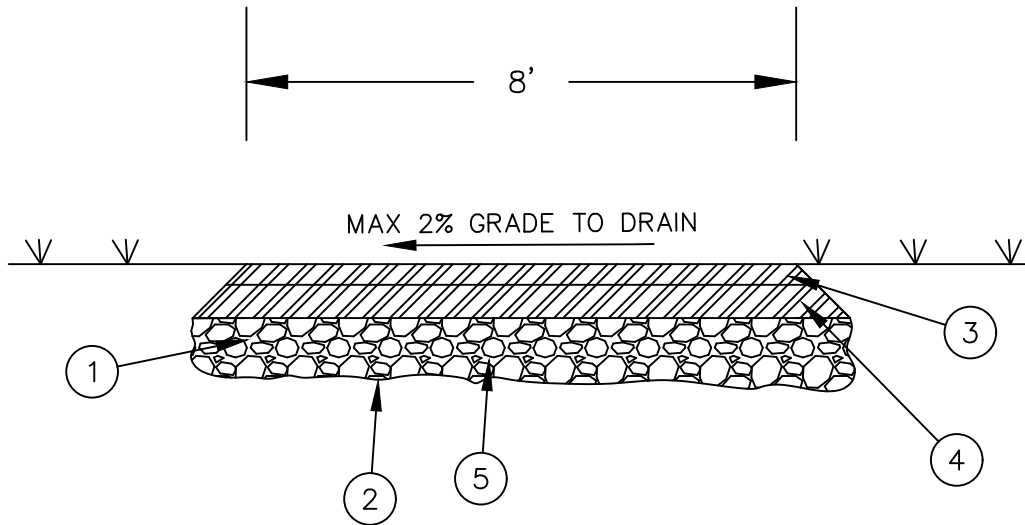

IMPROVEMENT LEGEND

- ① ITEM 203 – EXCAVATION
- ② ITEM 204 – SUBGRADE COMPACTION
- ③ ITEM C441 – 1½" ASPHALT CONCRETE SURFACE COURSE
- ④ ITEM C441 – 2½" ASPHALT CONCRETE INTERMEDIATE COURSE
- ⑤ ITEM C304 – AGGREGATE BASE, 6" MIN



CITY OF
CENTERVILLE, OH
PUBLIC WORKS DEPARTMENT
7970 SOUTH SUBURBAN ROAD
CENTERVILLE, OHIO 45458
PHONE (937) 428-4782
FAX (937) 433-0286

MULTI-USE TRAIL

Approval:

JAMES G. BRINEGAR
James Brinegar
City Engineer

Date: Sept. 2020

Revision:

SHEET
21

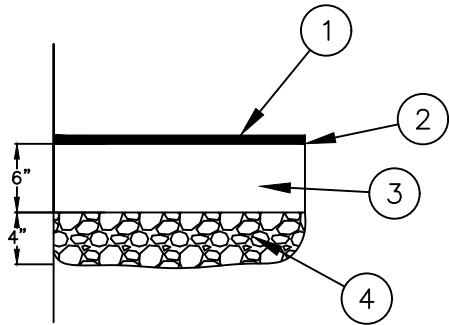

TYP. PARKING LOT PAVEMENT SECTION

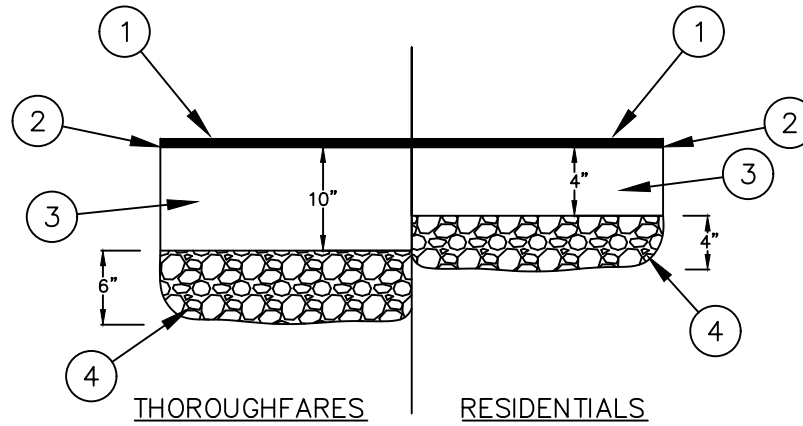

TYP. ROADWAY PAVEMENT SECTION

IMPROVEMENT LEGEND

- ① 2" ODOT ITEM 441 ASPHALT SURFACE COURSE
- ② ODOT ITEM 407 TRACKLESS TACK COAT
- ③ ODOT ITEM 301 ASPHALT BASE
- ④ ODOT ITEM 304 AGGREGATE BASE

Date: Jan. 2023 Revision: Jan. 2020	SHEET 22
PAVEMENT SECTIONS	
CITY OF CENTERVILLE, OH PUBLIC WORKS DEPARTMENT 7970 SOUTH SUBURBAN ROAD CENTERVILLE, OHIO 45458 PHONE (937) 428-4782 FAX (937) 433-0286	



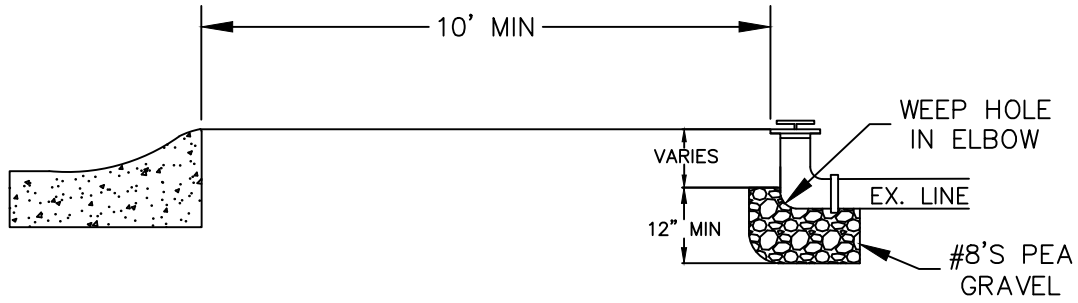

POP-UP DETAIL WITHOUT SIDEWALK
(SUMP PUMP OR DOWNSPOUT)

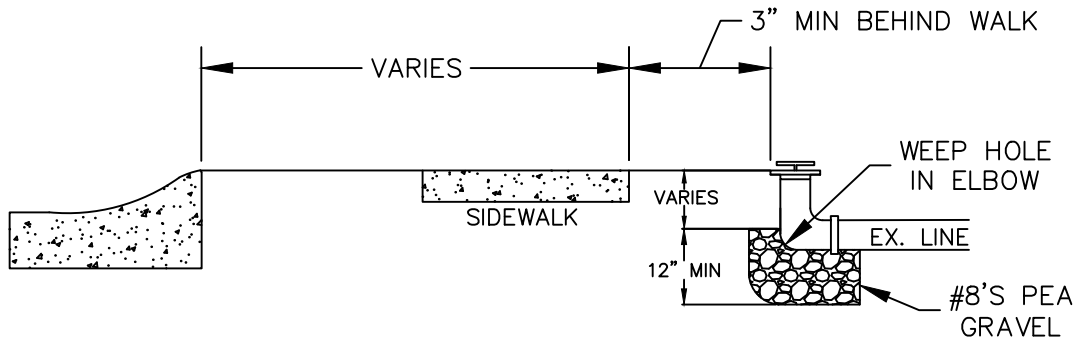

POP-UP DETAIL WITH SIDEWALK
(SUMP PUMP OR DOWNSPOUT)

Date: Jan. 2018
Revision: Jan. 2020
SHEET 23

Approval:
JAMES G. BRINEGAR
James Brinegar
City Engineer

POP-UP DETAIL

CITY OF
CENTERVILLE, OH
PUBLIC WORKS DEPARTMENT
7970 SOUTH SUBURBAN ROAD
CENTERVILLE, OHIO 45458
PHONE (937) 428-4782
FAX (937) 433-0286



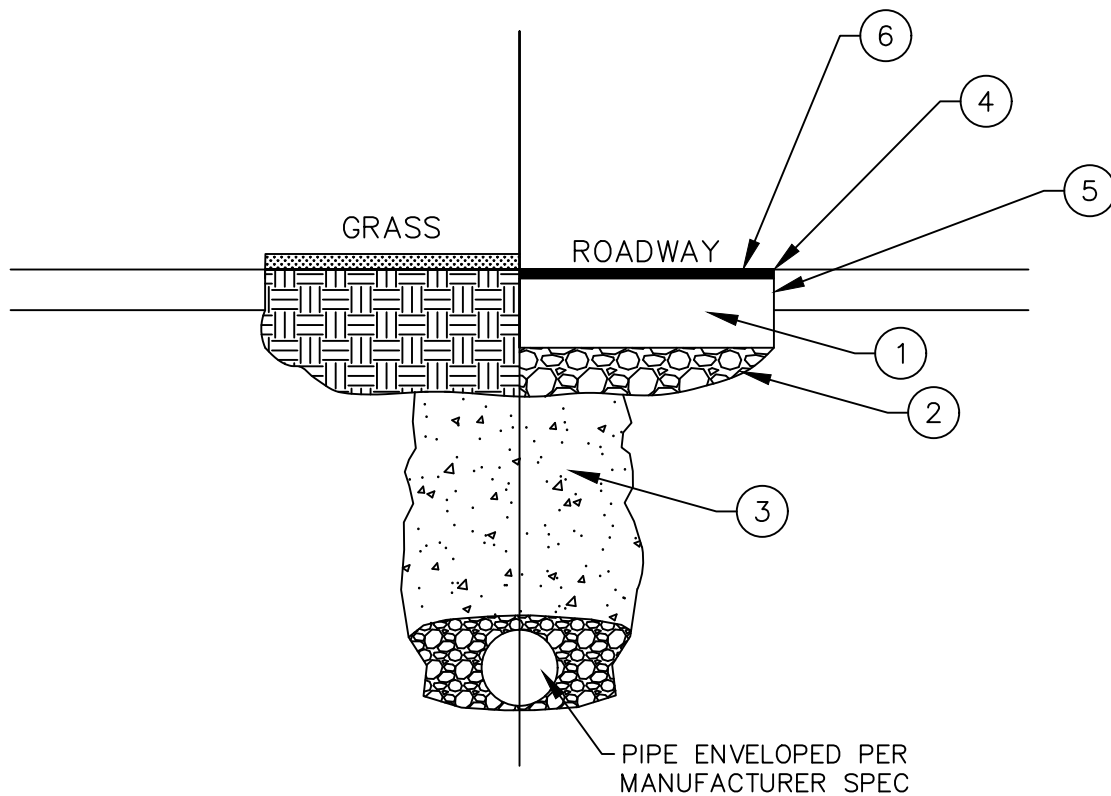

NOTES:

1. RESTORATION ON RESIDENTIAL ROADWAYS SHALL INCLUDE 4" ODOT ITEM 301 AND 2" OF ODOT ITEM 448. RESTORATION ON MAIN ROADWAYS SHALL INCLUDE 10" OF ODOT ITEM 301 AND 2" OF ODOT ITEM 441 (448).
2. ITEM 304 AGGREGATE BASE, COMPACTED, AS DIRECTED BY ENGINEER. 4" DEPTH ON RESIDENTIAL ROADWAYS AND 6" DEPTH ON MAIN ROADWAYS.

3. 98% COMPACTED ODOT ITEM 310 OR FLOWABLE FILL (LSM 100)
4. AC SEAL EDGE TOP
5. REAT ALL EDGES WITH JOINT ADHESIVE (ODOT 401.14)
6. ITEM C407 TRACKLESS TACK COAT
7. FOR OPEN-CUTS IN THE ROADWAY, GRAVEL, ODOT ITEM 310, OR FLOWABLE FILL (LSM 100) BACKFILL IS REQUIRED.
8. IF BORING OR POTHOLING THE ROADWAY, BACKFILL WITH FLOWABLE FILL.



CITY OF
CENTERVILLE, OH
PUBLIC WORKS DEPARTMENT
7970 SOUTH SUBURBAN ROAD
CENTERVILLE, OHIO 45458
PHONE (937) 428-4782
FAX (937) 433-0286

ROADWAY /
RIGHT-OF-WAY
CUTS

Approval:

JAMES G. BRINEGAR
James Brinegar
City Engineer

Date: June 2021

Revision:

SHEET
24

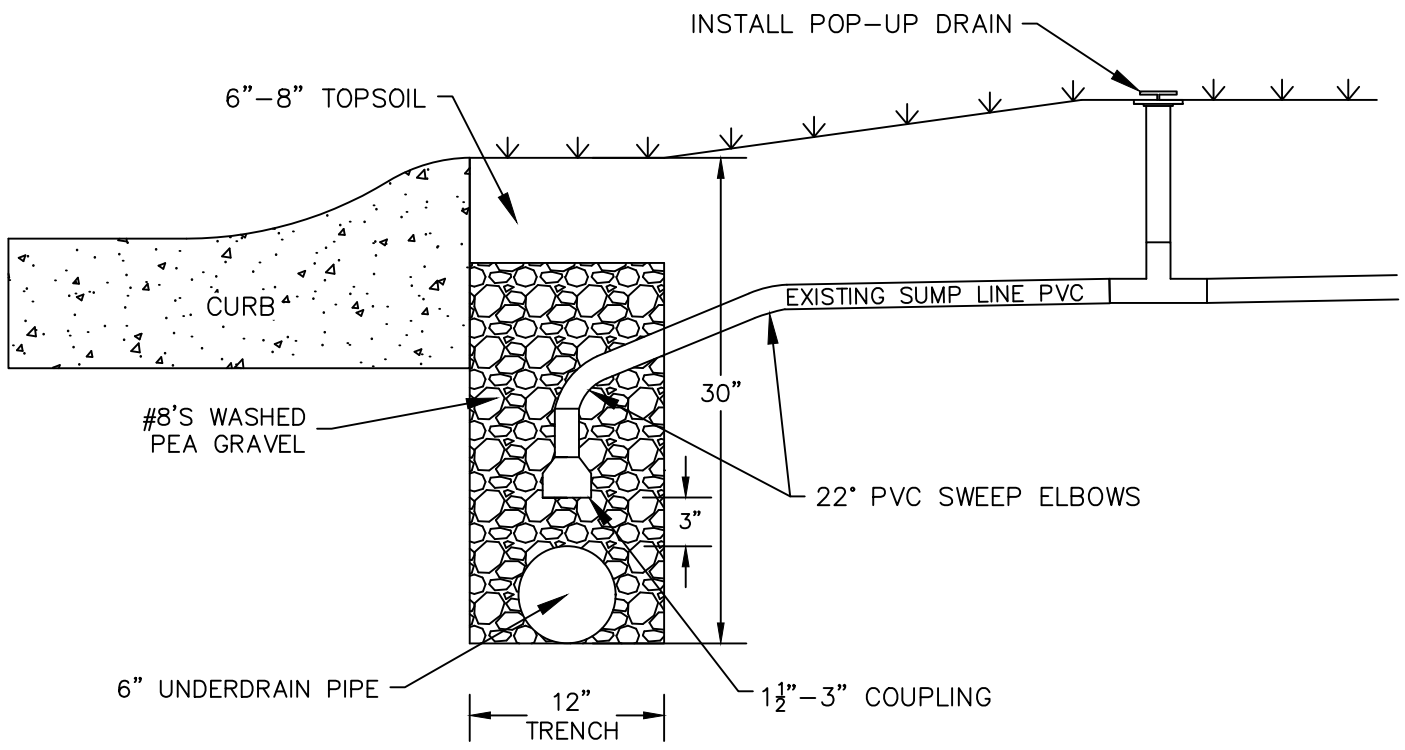

SUMP LINES ONLY, NO DOWNSPOUTS, NO YARD DRAINS



CITY OF
CENTERVILLE, OH
PUBLIC WORKS DEPARTMENT
7970 SOUTH SUBURBAN ROAD
CENTERVILLE, OHIO 45458
PHONE (937) 428-4782
FAX (937) 433-0286

SPECIAL -
SUMPLINE
CONNECTION

Approval:
JAMES G. BRINEGAR
James Brinegar
City Engineer

Date: Jan. 2020

Revision:

SHEET
25